

T. 18 S. R. 46 E. W. M.

*Survey sealed
use WSID final proof*

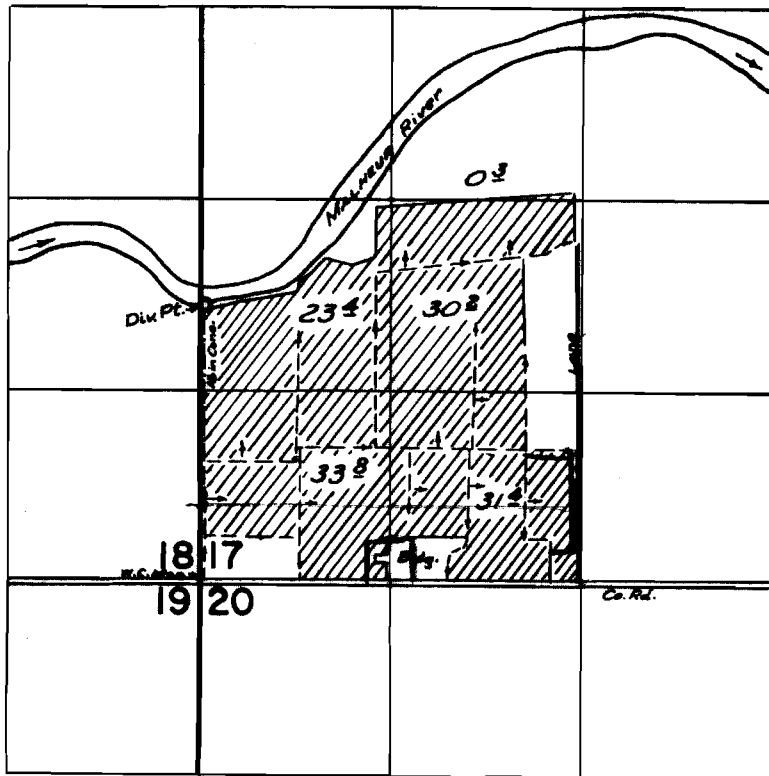

Dir. Pt. : 1900' N of 30' E from SW cor Sec. 17

FINAL PROOF SURVEY UNDER

Application No. 30415 Permit No. 23982
IN NAME OF

MAYFRED SPENCER PARKHURST

Surveyed 27 Oct. 1960, by M. B. [Signature]

T. 18S., R. 46E., W.M.

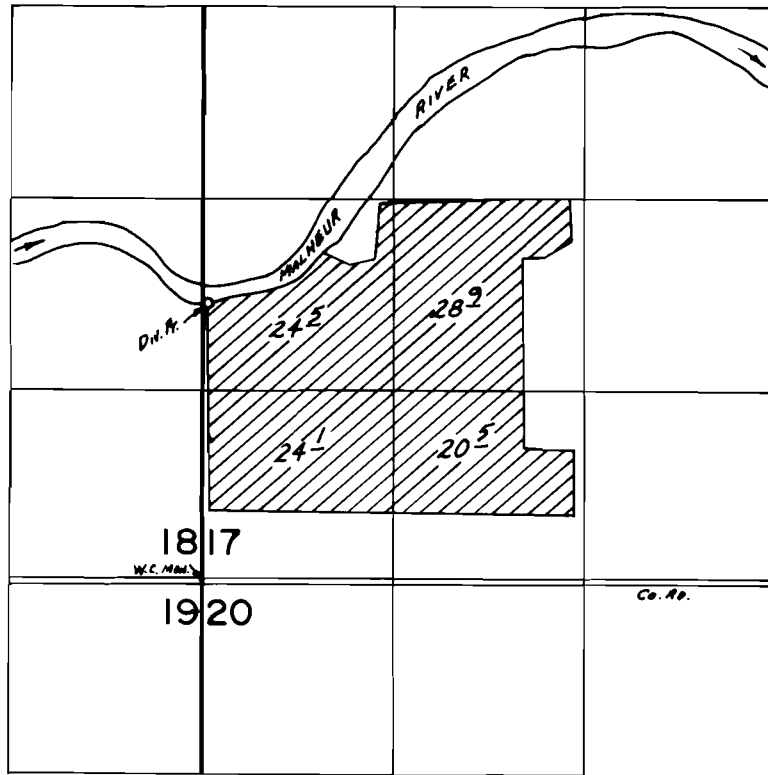

DIV. PT.: 1900'N. & 30'E. FROM SW COR. SEC. 17

FINAL PROOF SURVEY
UNDER

Application No. 30415... Permit No. 23982.....
IN NAME OF

.....MAYFRED SPENCER PARKHURST.....

Surveyed Oct. 27... 1960, by M. BISH.....