

T. 1 S., R. 9 W., W.M.

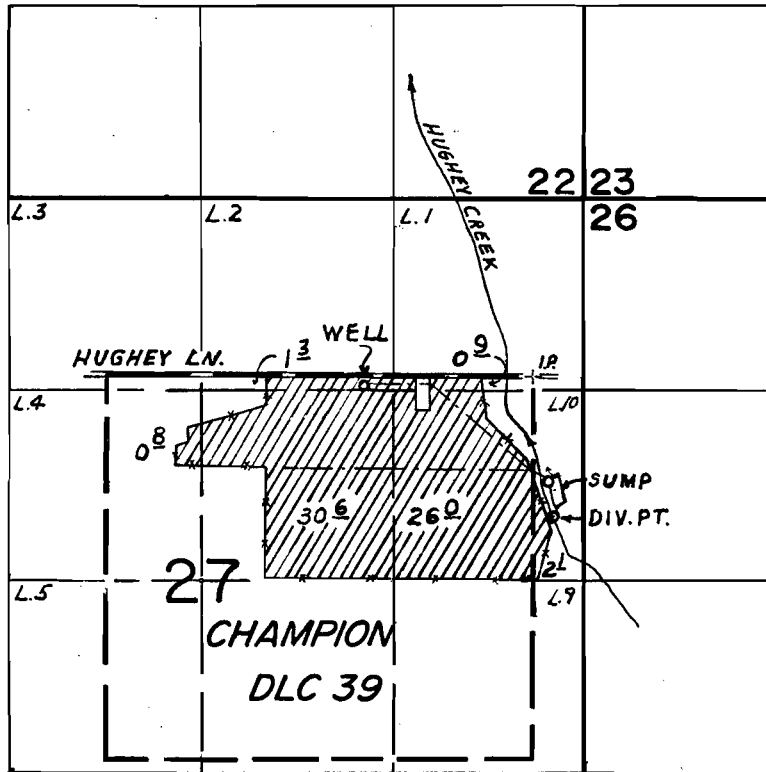

Div. Pt. Loc. 980' S. & 140' E., Well Loc. 50' S. & 1160' W.,
Both From NE Cor. DLC 39.

FINAL PROOF SURVEY UNDER

G-6379
48781
Application No. R-48780. Permit No. R-6136....
G-5971 (Suppl)
37936 (Primary)
IN NAME OF

GEORGE HODGDON

Surveyed May. 24... 1978, by J.S. DONALDSON