

T.14S., R.1W., W.M.

Application No. 56916

Permit No. 42701

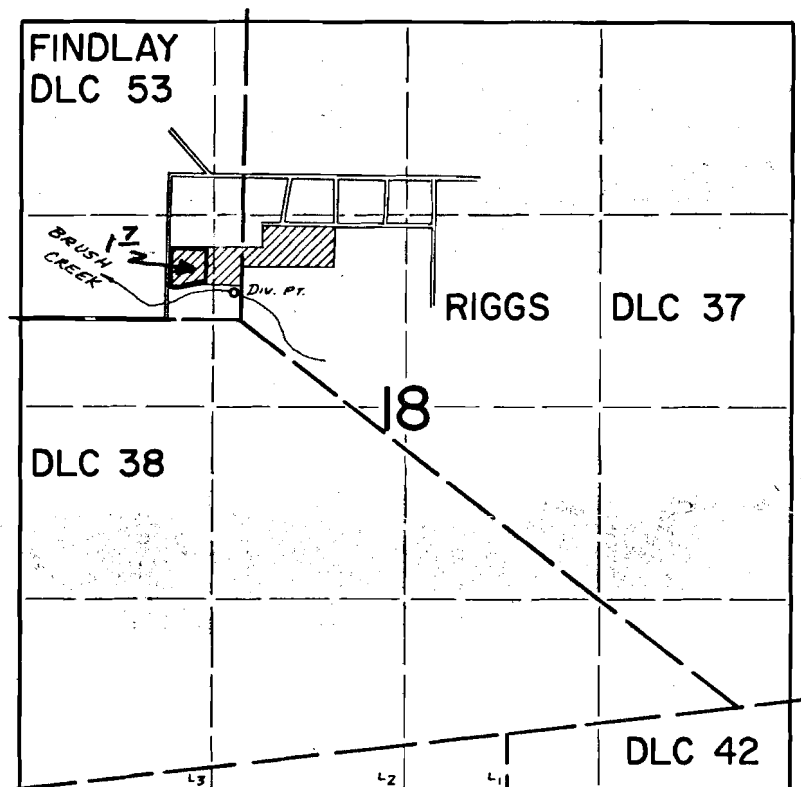

DIV. PT. LOC: 190' N & 50' W FROM SE COR. FINDLAY DLC 53.

**FINAL PROOF SURVEY**  
UNDER

RECEIVED  
SEP 12 1975  
WATER RESOURCES DEPT  
SALEM, OREGON

Application No. ~~46834~~ Permit No. ~~35022~~  
IN NAME OF

ALBERT AND VIRGINIA SCHUSTER

Surveyed Sept. 5 1975, by D. Norby