

T. 2S. R. 3W. W.M.

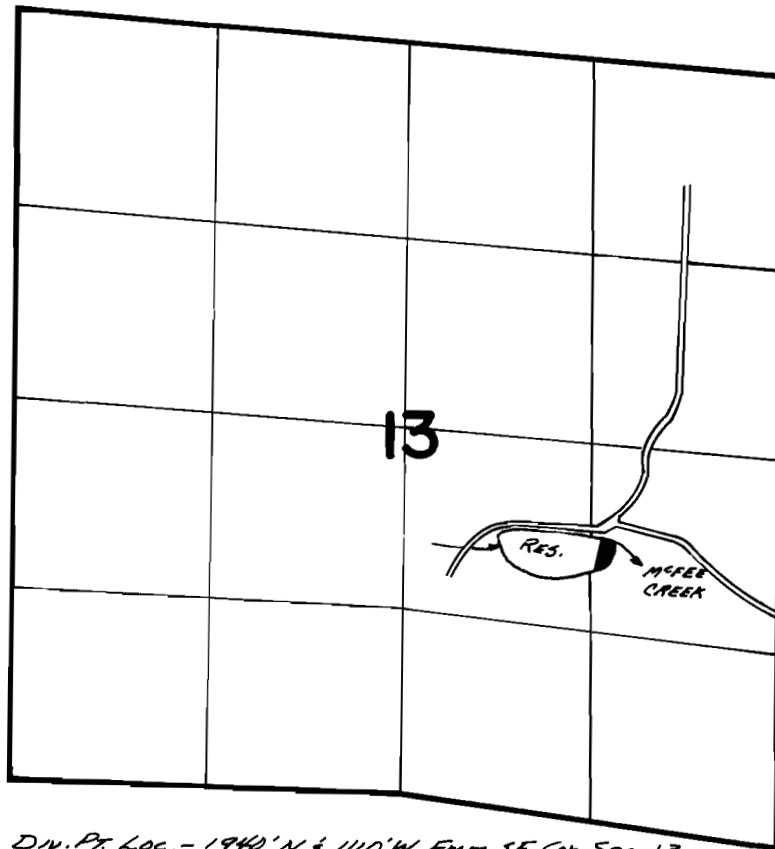

Div. Pt. Loc. - 1940' N & 1110' W From SE Cor. Sec. 13

**FINAL PROOF SURVEY
UNDER**

R-49042 R-5788
Application No. 49079 Permit No. 35829
IN NAME OF

.....DONALD H. HANSEN.....

Surveyed MAY 3, 1977., by D.M. NORBY.....