

T. 5S., R. 5W., W.M.

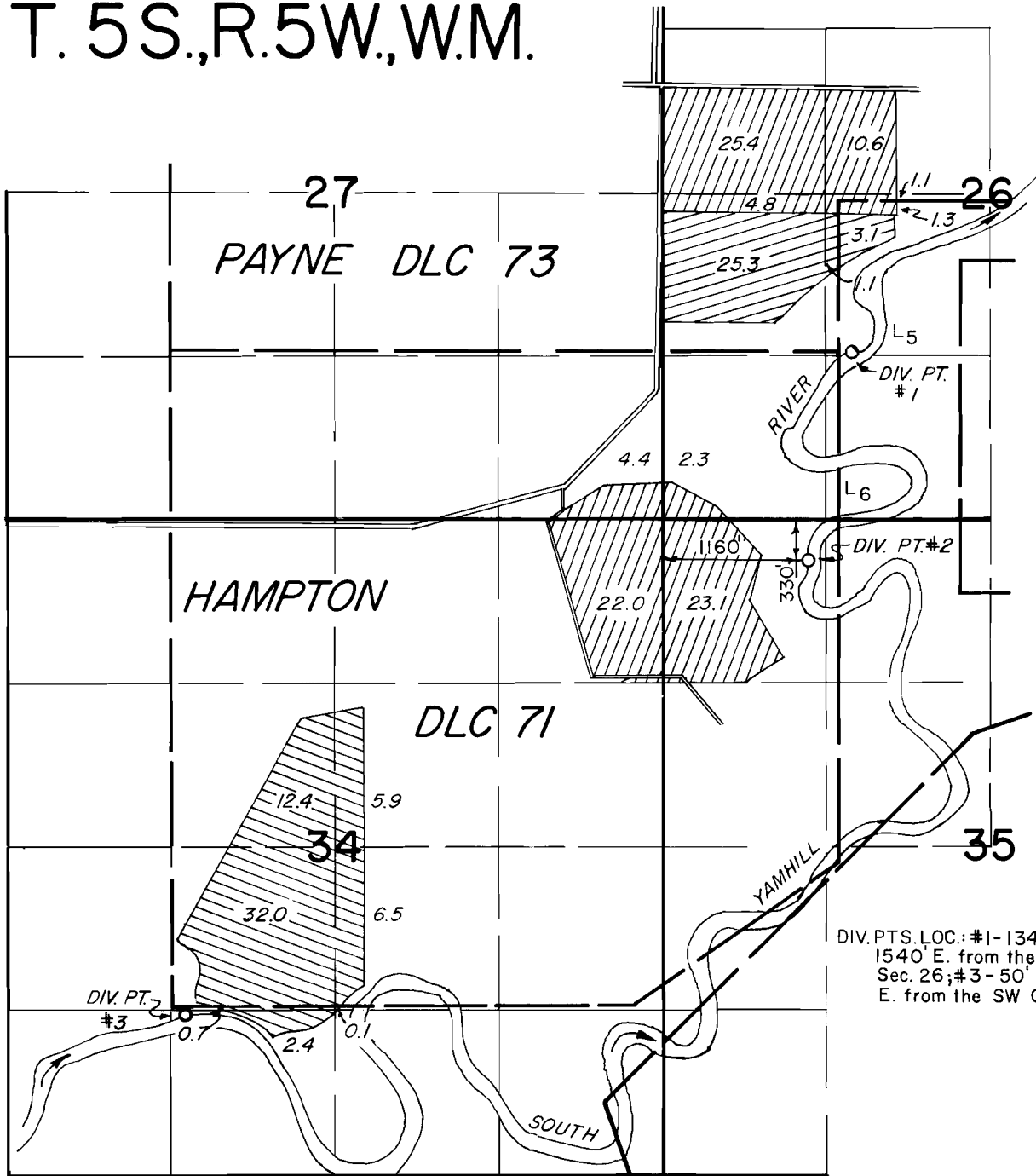

DIV. PTS. LOC.: #1- 1340' N. &
1540' E. from the SW Cor.,
Sec. 26; #3- 50' S. & 120'
E. from the SW Cor. DLC 71

FINAL PROOF SURVEY UNDER

Application No. 54471 Permit No. 40859
54472 40860
55832 42508

IN NAME OF

CRIMSON WEST FARMS

Surveyed JULY 20, 1977, by [Signature]
MAY 31, 1979

