

T.28S. R.14W. W.M.

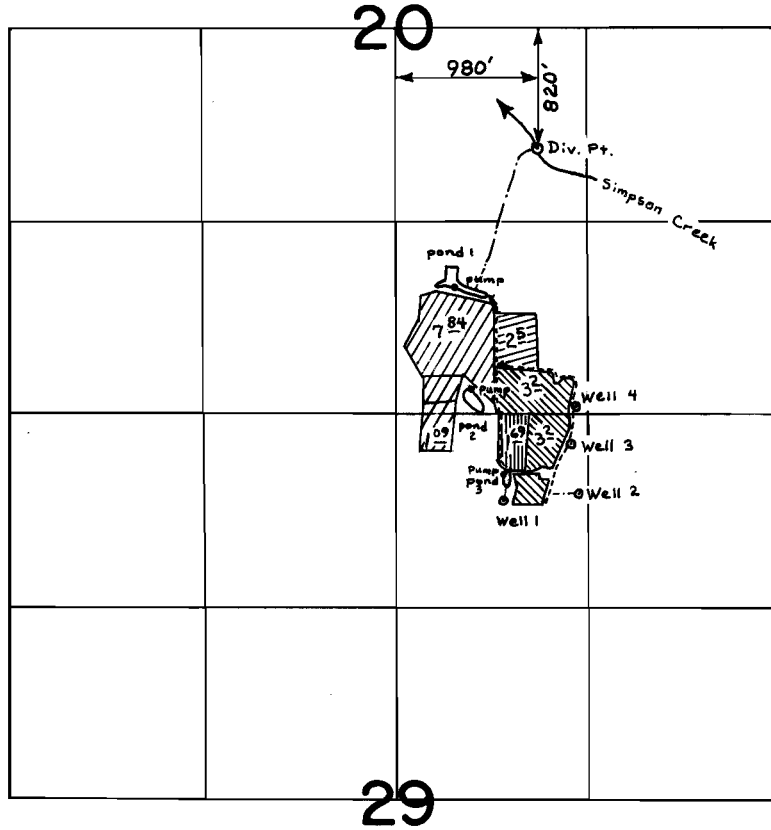

Wells Located: 1- 600'S & 750'E ; 2- 550'S & 1260'E ; 3- 200'S & 1200'E ;
 4- 50'N & 1240'E ; From N¹/₄ cor. Sec. 29

SCALE: 4" = 1 mile

FINAL PROOF SURVEY UNDER

G-7263 G-6783
 51614 40581
 R-48308 R-5809





Application No. 48309 Permit No. 35941

IN NAME OF

WILLIAM M. SOPER

Surveyed June 12, 1980, by S. Donaldson

Irrigation

	Permit No.
A  Primary Suppl.	11966 G-6783
B  Primary	G-6783
C  Primary Suppl.	40581 G-6783
D  Primary Suppl.	26056 35941 G-6783

Frost Control 35941 A,B,D
 40581 C
 G-6783 all

Harvesting G-6783 all
 40581 c