

# T.36 S., R.7 W., W.M.

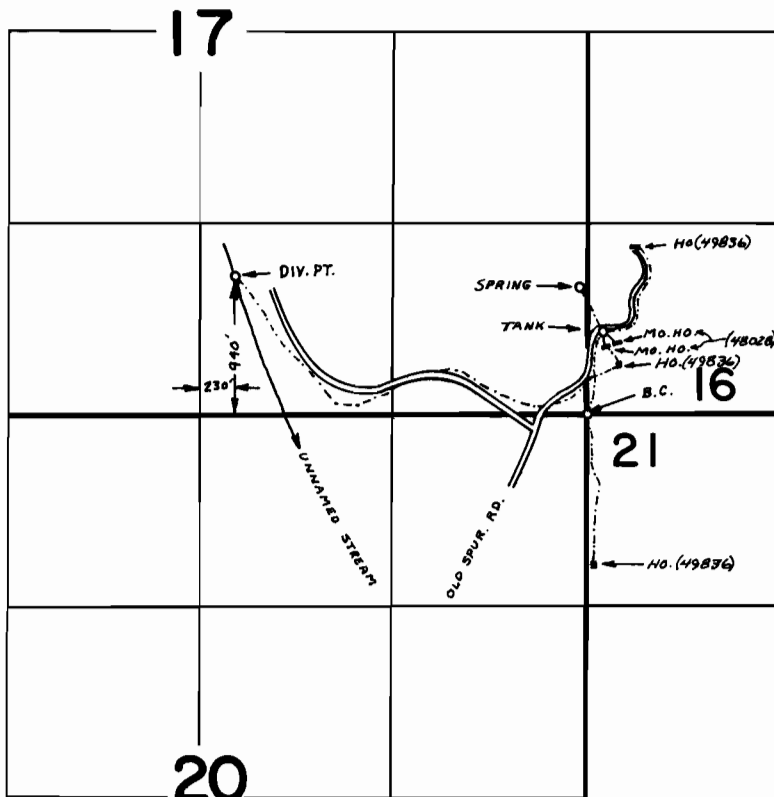

SPRING LOC.: 880' N. & 40' W. FROM SE COR. SEC. 17

## FINAL PROOF SURVEY UNDER

48028                      37812  
49836                      37813

Application No. .... Permit No. ....

IN NAME OF

WILLARD W. GRAHAM

Surveyed DEC. 7 77 by B. SUND  
19.....