

T.8S. R.3W., W.M.

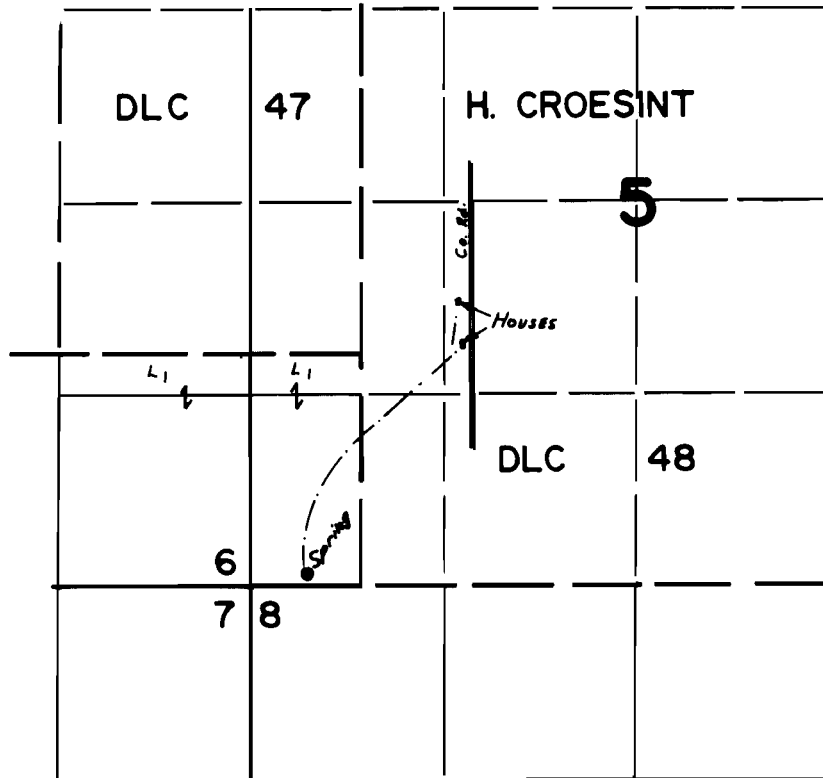

SPRING LOC. 70' N. & 380' E. FROM S.W. COR. SEC. 5

FINAL PROOF SURVEY UNDER

Application No. 49369... Permit No. 37008...
IN NAME OF

.....PETER SCHWEIGERT.....

Surveyed OCT. 18... 1978., by S.P. APPLGATE