

T.27S. R.19E. WM.

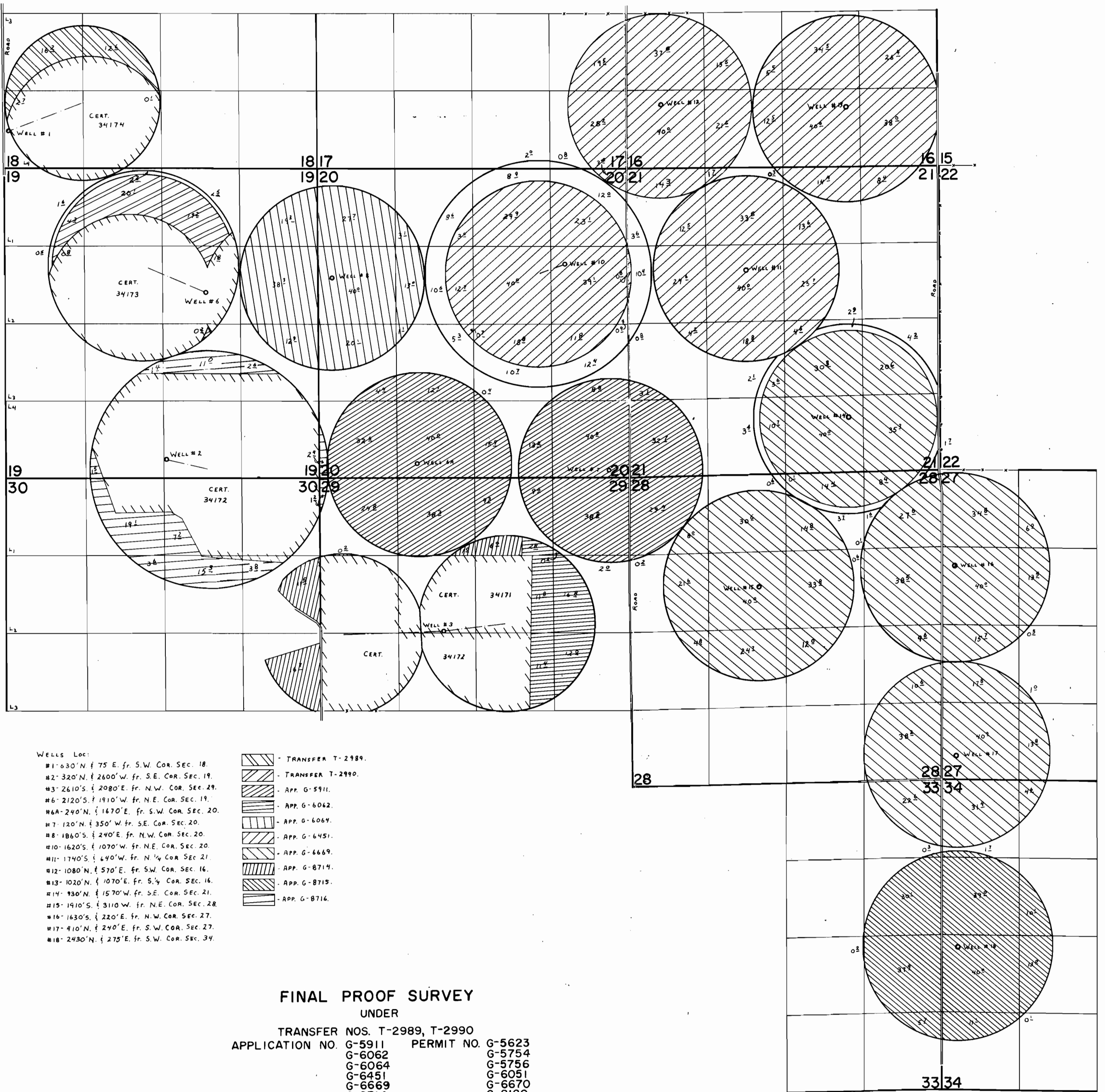

- WELLS LOC:
- #1-630' N. & 75' E. fr. S.W. COR. SEC. 18.
 - #2-320' N. & 260' W. fr. S.E. COR. SEC. 19.
 - #3-2610' S. & 2080' E. fr. N.W. COR. SEC. 29.
 - #6-2120' S. & 1910' W. fr. N.E. COR. SEC. 19.
 - #6A-240' N. & 1670' E. fr. S.W. COR. SEC. 20.
 - #7-120' N. & 350' W. fr. S.E. COR. SEC. 20.
 - #8-1860' S. & 240' E. fr. N.W. COR. SEC. 20.
 - #10-1620' S. & 1070' W. fr. N.E. COR. SEC. 20.
 - #11-1740' S. & 640' W. fr. N. 1/4 COR. SEC. 21.
 - #12-1080' N. & 570' E. fr. S.W. COR. SEC. 16.
 - #13-1020' N. & 1070' E. fr. S. 1/4 COR. SEC. 16.
 - #14-930' N. & 1570' W. fr. S.E. COR. SEC. 21.
 - #15-1910' S. & 3110' W. fr. N.E. COR. SEC. 28.
 - #16-1630' S. & 220' E. fr. N.W. COR. SEC. 27.
 - #17-410' N. & 240' E. fr. S.W. COR. SEC. 27.
 - #18-2430' N. & 275' E. fr. S.W. COR. SEC. 34.

- TRANSFER T-2989.
- TRANSFER T-2990.
- APP. G-5911.
- APP. G-6062.
- APP. G-6064.
- APP. G-6451.
- APP. G-6669.
- APP. G-8714.
- APP. G-8715.
- APP. G-8716.

FINAL PROOF SURVEY
 UNDER
 TRANSFER NOS. T-2989, T-2990
 APPLICATION NO. G-5911 PERMIT NO. G-5623
 G-6062 G-5754
 G-6064 G-5756
 G-6451 G-6051
 G-6669 G-6670
 G-8714 G-8120
 G-8715 G-8121
 G-8716 G-8122

IN NAME OF

ALDER CREEK RANCH

SURVEYED AUG. 26, 1979, by C. L. HUGHES