

T.29S. R.4W. W.M.

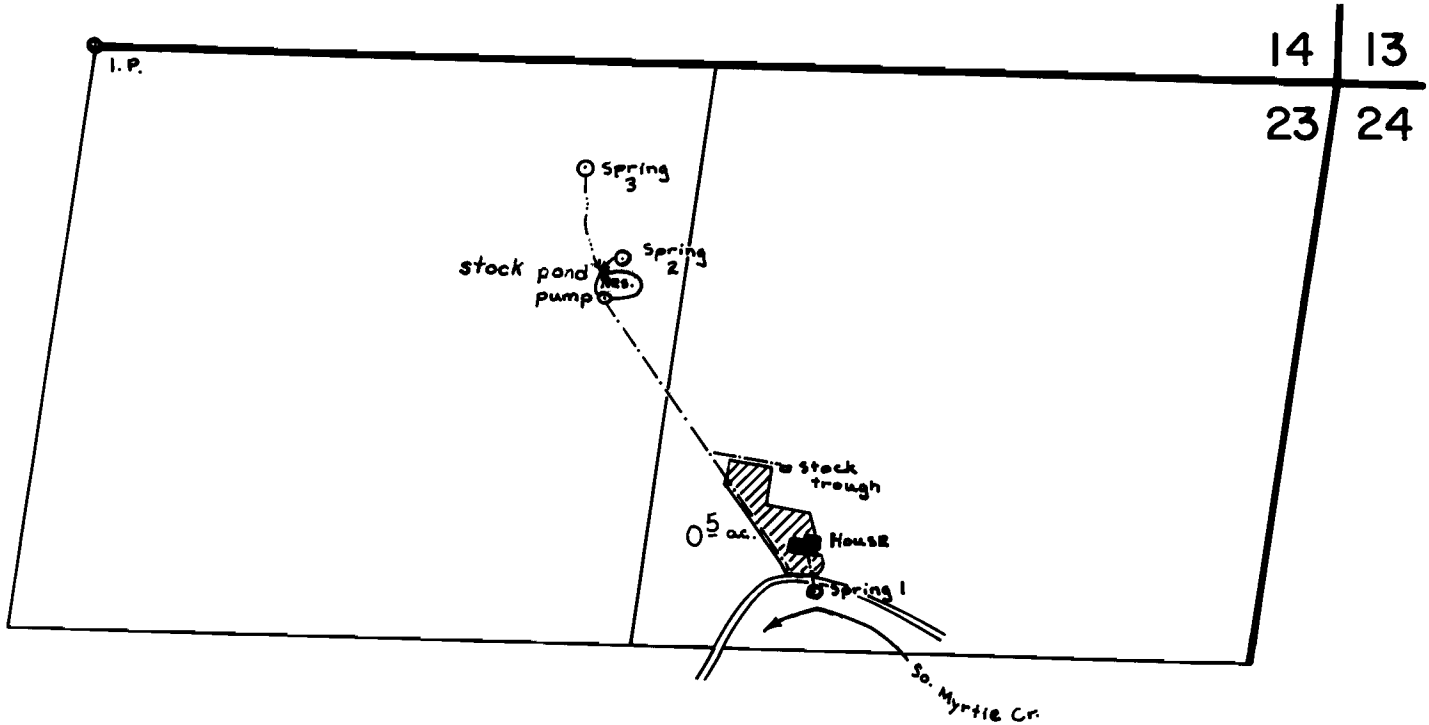

Reservoir Located: 440'S & 1550'W
Springs Located: 1- 1050'S & 1100'W
2- 360'S & 1500'W
3- 170'S & 1580'W
all from the NE Cor. of Sec. 23

SCALE: 1" = 400'

FINAL PROOF SURVEY
UNDER

R-57393 R-7702
Application No. 57394 Permit No. 43476
IN NAME OF
LEON DUPPER

Surveyed Nov. 8 1978, by S. Donaldson