

T.37S., R.2W., W.M.

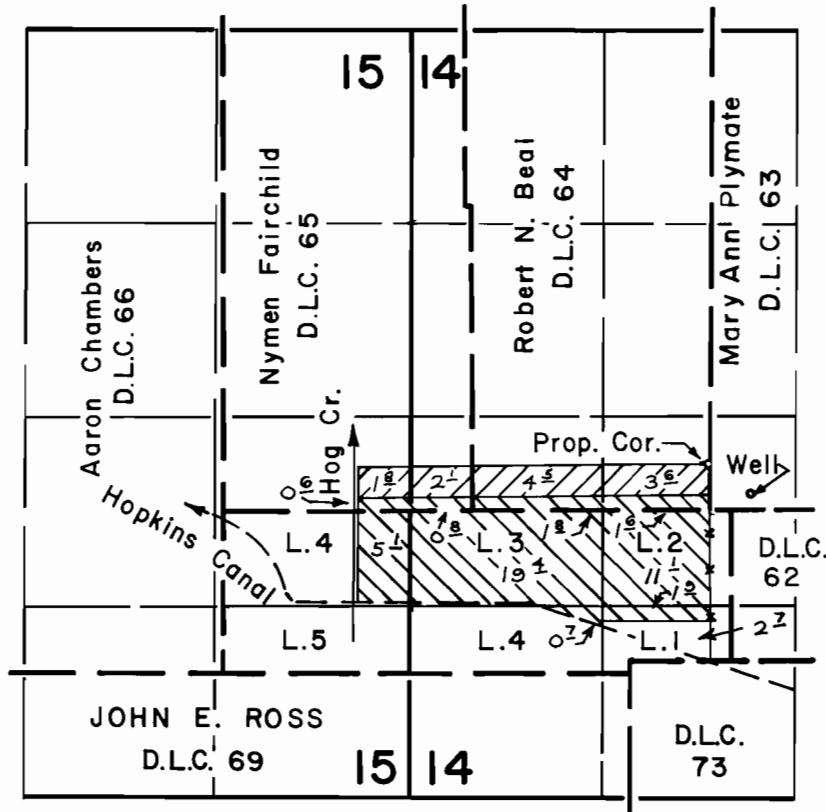

Well Loc. - 2100' N. & 2330' E. From S.W. Cor. Sec. 14

▨ PRIMARY ▨ SUPPL.

FINAL PROOF SURVEY UNDER

Application No. G-6509 Permit No. G-6122
IN NAME OF

GEORGE C. FLANAGAN

Surveyed OCT. 6 1978, by B. SUND

D.H.M.
P.T.S. - 1978-14-D