

T.6S.R.IW.W.M.

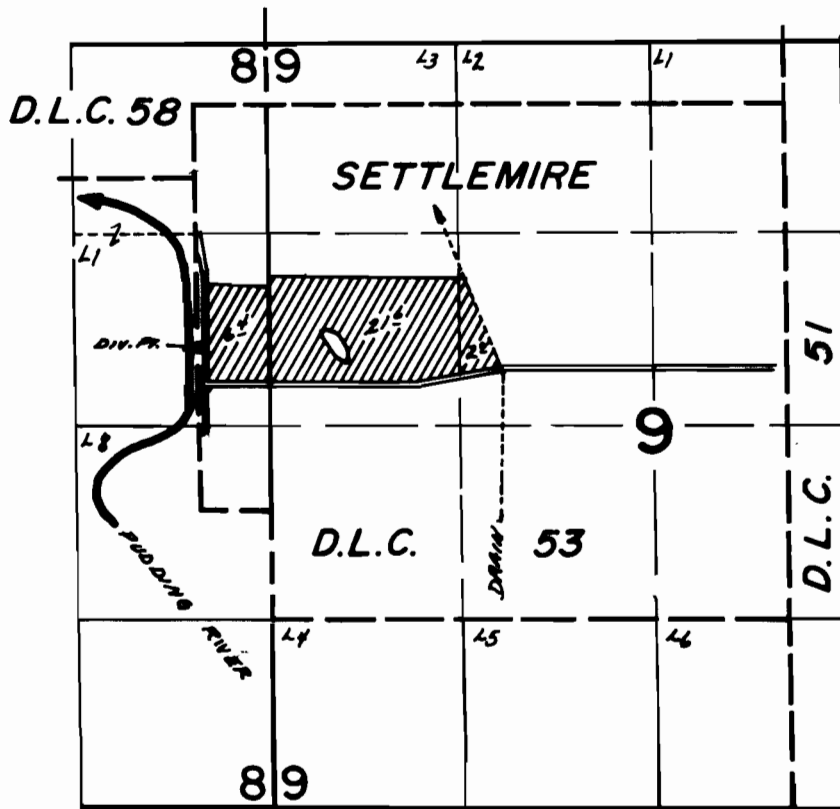

Div. Pt. Loc. - 540' N. & 470' W. from E 1/4 Cor. SEC. 8

FINAL PROOF SURVEY UNDER

Application No. 56702.. Permit No. 42008..
IN NAME OF

.....JOHN N. SEVERIN.....

Surveyed Oct. 4... 1978., by J.S. Donaldson..