

T.4S.R2&3W. W.M.

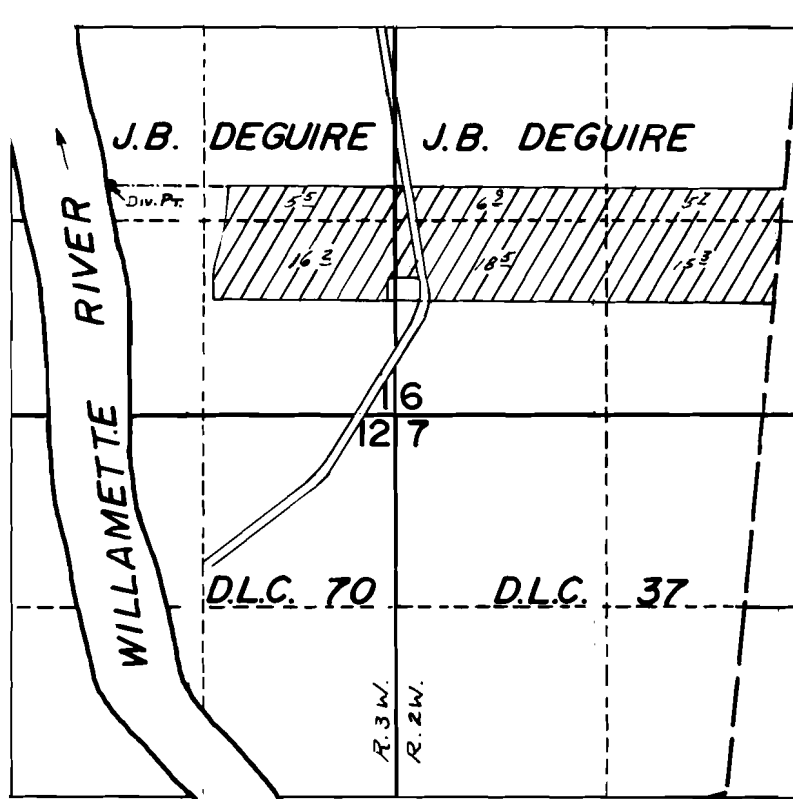

Div. Pt. Loc. - 1570' N & 1950' W from SE Cor. SEC. 1

FINAL PROOF SURVEY UNDER

Application No. 57.302. Permit No. 43088.
IN NAME OF

A.F. JUNGWIRTH

Surveyed Aug. 17, 1978, by J.S. Donaldson