

T6S. R6W. WM.

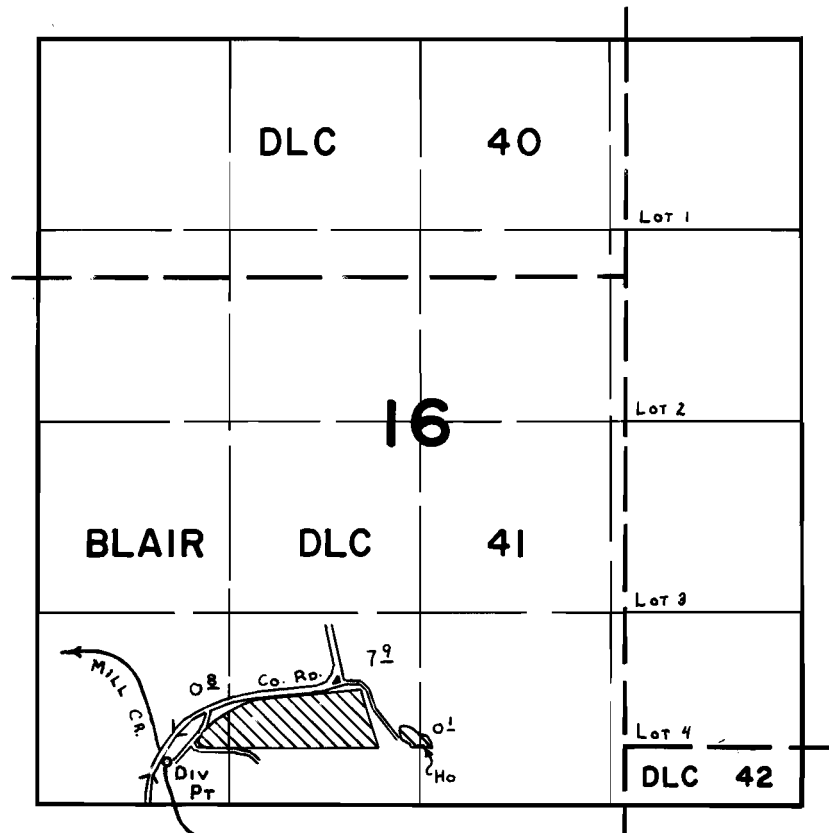

Div. Pt. Loc: 280' N & 880' E. fr. SW Cor. Sec 16.

FINAL PROOF SURVEY UNDER

Application No. 53421 Permit No. 39752
IN NAME OF

MARK MILLIKAN

Surveyed SEPT. 5 1978, by C. L. HUGHES