

T.6S., R.7W., W.M.

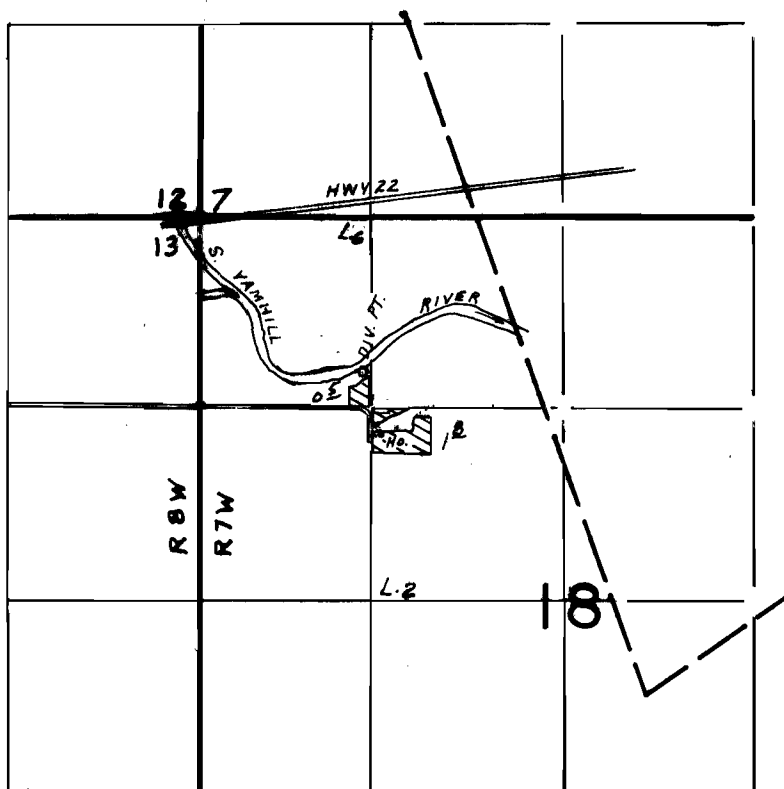

Div. Pt. Loc. 1090' S. & 1140' E. From NW Cor. Sec. 18

FINAL PROOF SURVEY
UNDER

Application No. 53737... Permit No. 40356..
IN NAME OF

.....
ESTEL G. WRIGHT
.....

Surveyed Mar..15.... 1978, by J.S..DONALDSON