

T.5S.,R.5W.,W.M.

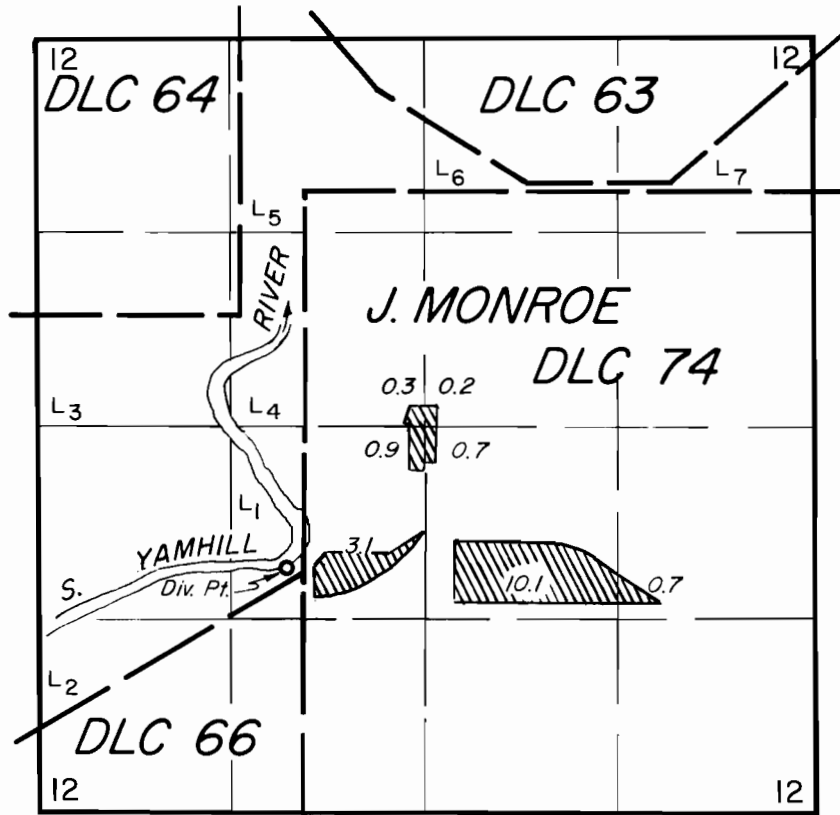

DIV. PT. LOC.: 2600' S. & 120' W., from the NW corner DLC 74

FINAL PROOF SURVEY

UNDER

Application No. 41837 Permit No. 31310
IN NAME OF

Barbara C. Devine

Surveyed MAY 31, 1979, by *J. B. Brown*