

T. 8S. R. 39E. W.M.

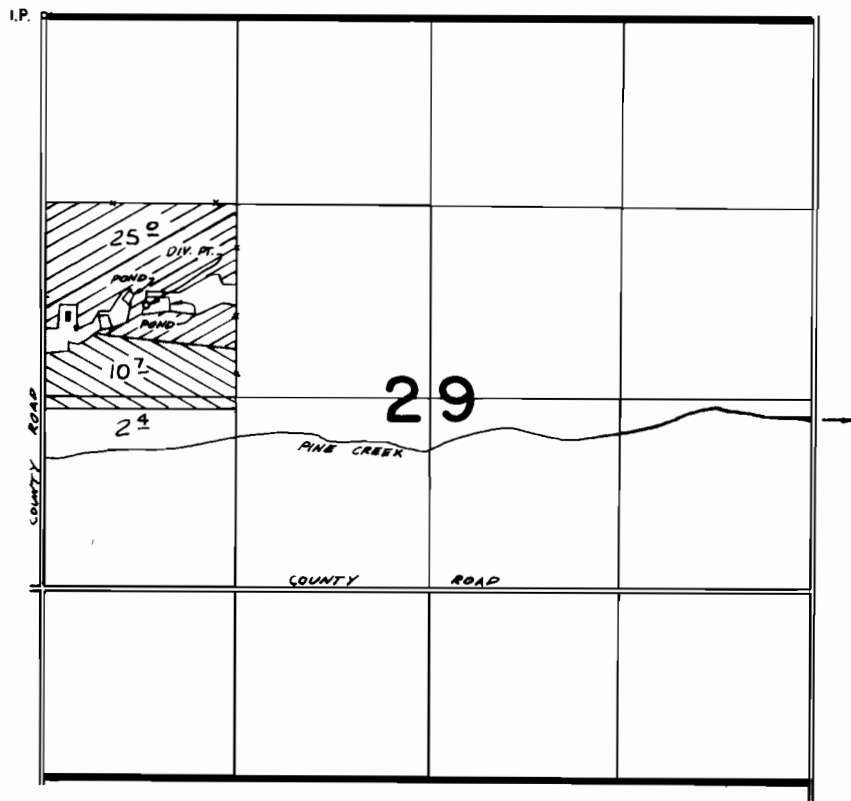

DIV. PT LOC. 630' N & 700' E FROM W 1/4 COR SEC 29



PRIMARY



SUPP'L

FINAL PROOF SURVEY UNDER

Application No. G-5502 Permit No. G-5399
IN NAME OF

WISTER M. JR., & CHARLOTTE M. ADAIR

Surveyed 6-5 1978, by R. BARWIN