

T5S. R3E. WM.

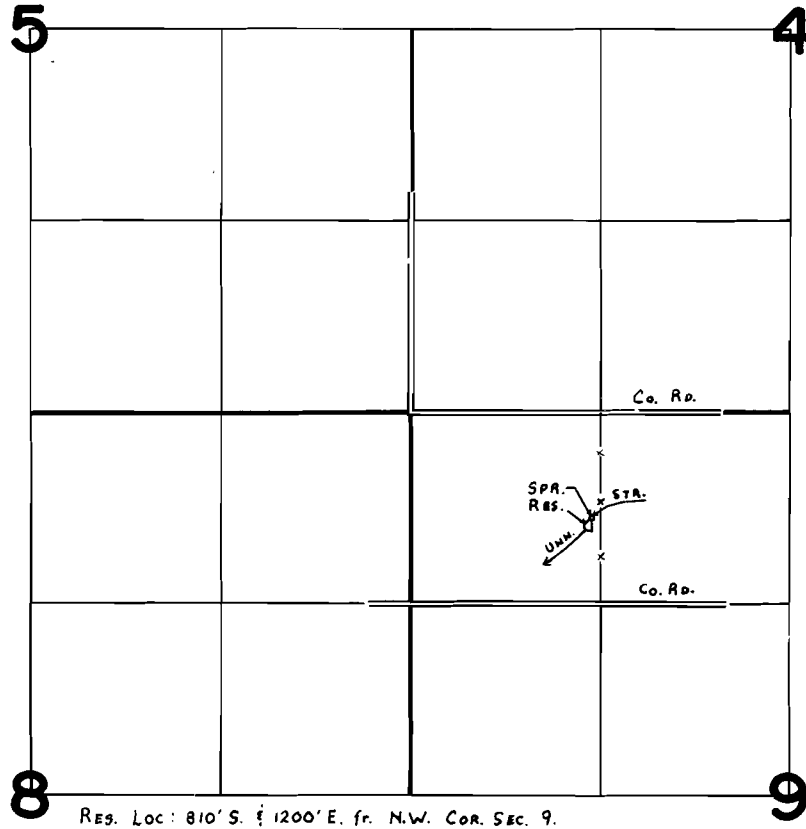

Res. Loc: 810' S. & 1200' E. fr. N.W. Cor. Sec. 9.

**FINAL PROOF SURVEY**  
UNDER

49855 37491  
Application No. R-49876 Permit No. R-6087  
IN NAME OF

**WILLIAM C. OLNEY & MARY L. J. WHEELER**

Surveyed SEPT. 25 1978, by C. L. HUGHES.