

T.28S. R.14W. W.M.

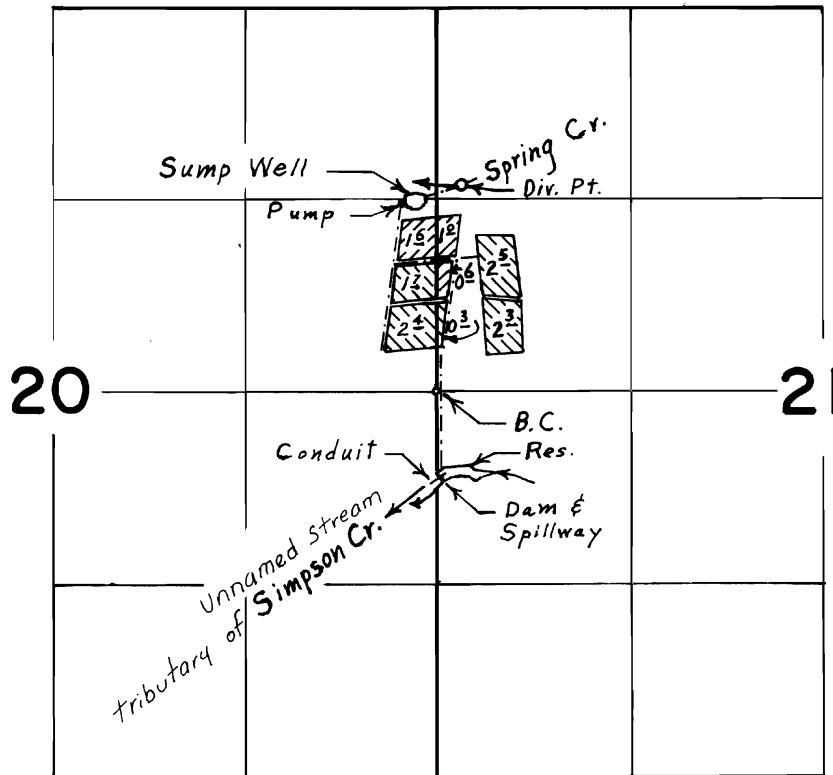

Div. Pts. located: Spr. Cr., 1420' N. & 170' E.; Sump Well, 1320' N. & 150' W.; Simpson Cr., 580' S. & 20' E. from W. $\frac{1}{4}$ Cor. Sec. 21.

Primary 
 Supplemental 

FINAL PROOF SURVEY UNDER

G - 4529 G - 4266
 R - 45458 R - 5402
 Application No. 45246 Permit No. 34059
 IN NAME OF

W. J. PULLEN

Surveyed Aug. 25, 1976, by L. E. Gould.