

T.32½33S. R.6½7W. W.M.

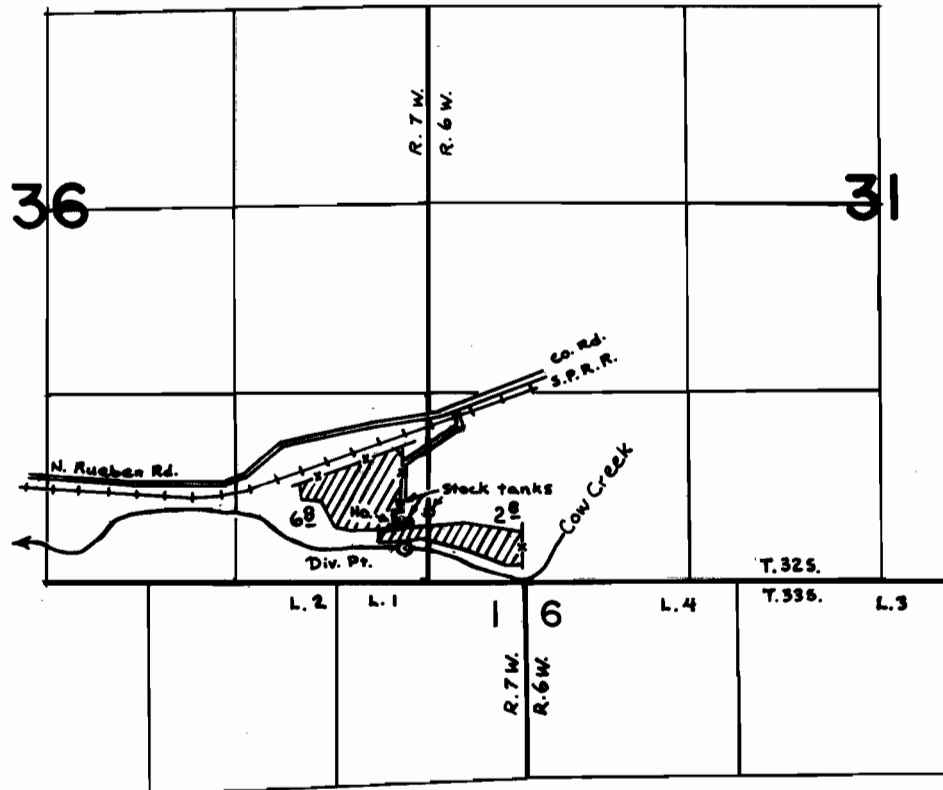

Div. Pt. Located: 220' N & 150' W from the SE cor. of Sec. 36, T. 32S., R. 7W., W.M.

SCALE: 4" = 1 mile

FINAL PROOF SURVEY UNDER

Application No. 47614 Permit No. 35639
IN NAME OF

VERNON E. & BILLIE JANE JONES

Surveyed Oct. 16, 1979, by S. Donaldson