

# T.28S., R.7W., W.M.

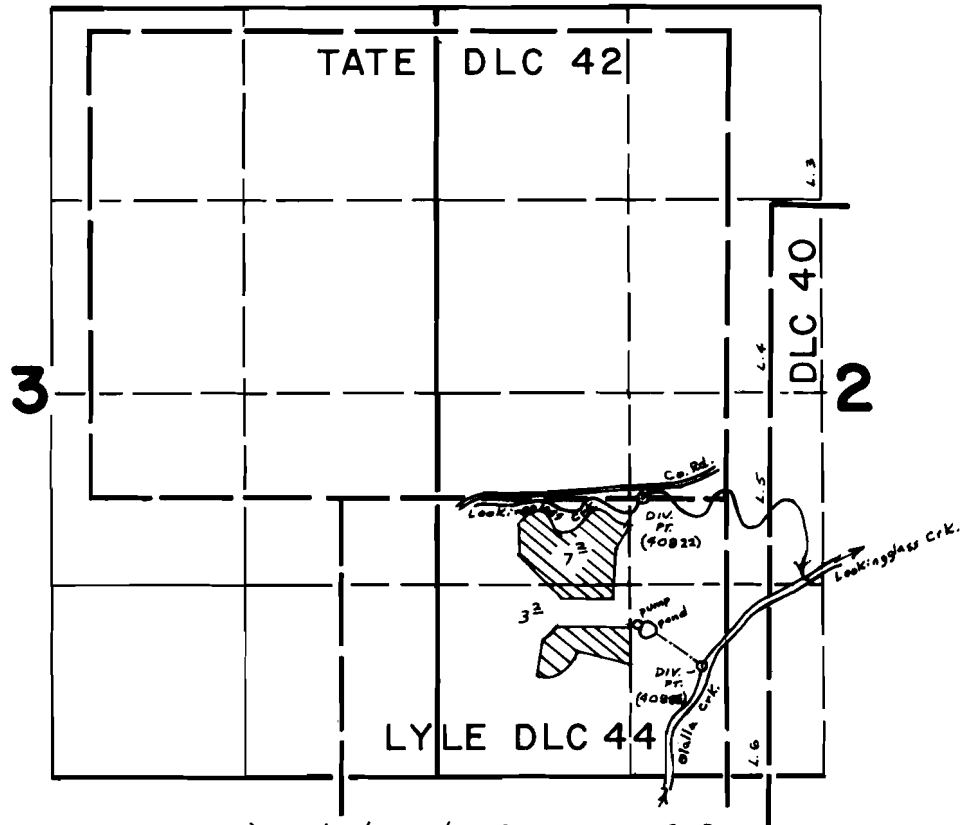

DIV. PT. (40822) 1900' N & 1400' E from SW cor. Sec 2  
 DIV. PT. (40888) 750' N & 1800' E from SW cor. Sec 2

SCALE 4" = 1 mile

## FINAL PROOF SURVEY UNDER

54435                      40822

Application No. 54435..... Permit No. 40888.  
 IN NAME OF

.....BRUNDIGE & POPKEN TRUCKING INC.

Surveyed June 7, 1979, by S. Donaldson..