

T. 39S., R. 7 W., W.M.

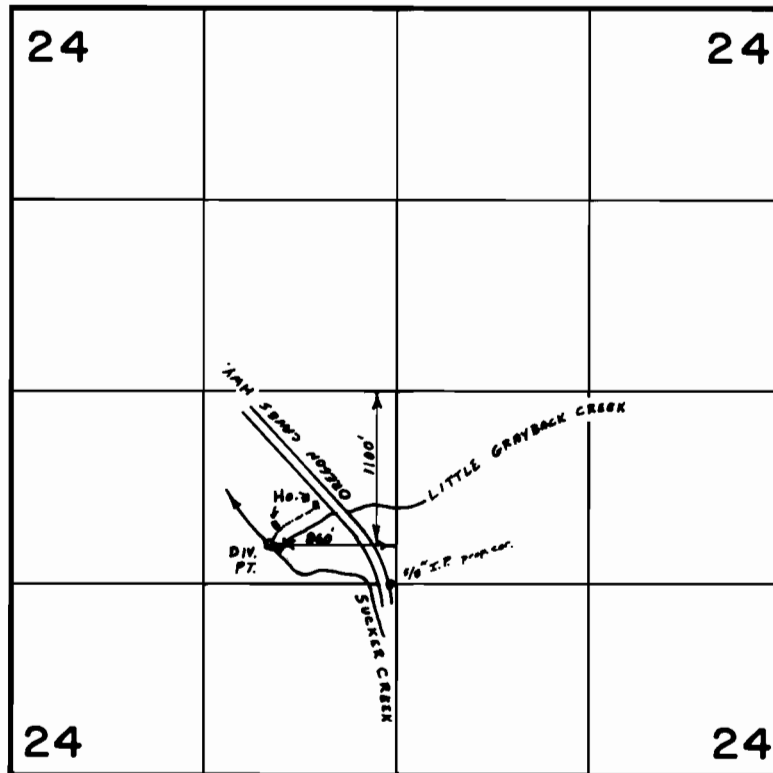

Scale 4" = 1 mile

**FINAL PROOF SURVEY**  
UNDER

Application No. ~~41426~~ Permit No. 30940...  
IN NAME OF

**CHARLES...DEAN...&...ANNA...M...McBRIDE**

Surveyed April 29, 1980, by B.R. SUND.....