

T.36S.,R.6W.,W.M.

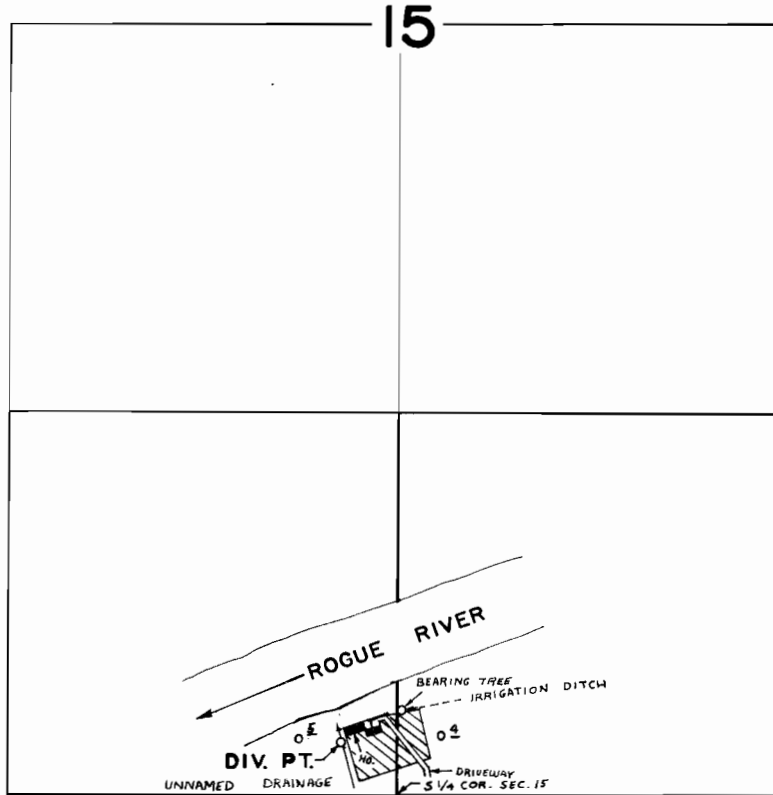

DIV. PT. LOC.: 185' N. & 185' W. FROM S. 1/4 COR. SEC. 15
SCALE: 1" = 660'

FINAL PROOF SURVEY UNDER

Application No. 52499 Permit No. 39631
IN NAME OF

MORRIS & ADELE SHIMANOFF

Surveyed SEPT. 20 1977, by B. SUND