

T. 6S.R.2W.W.M.

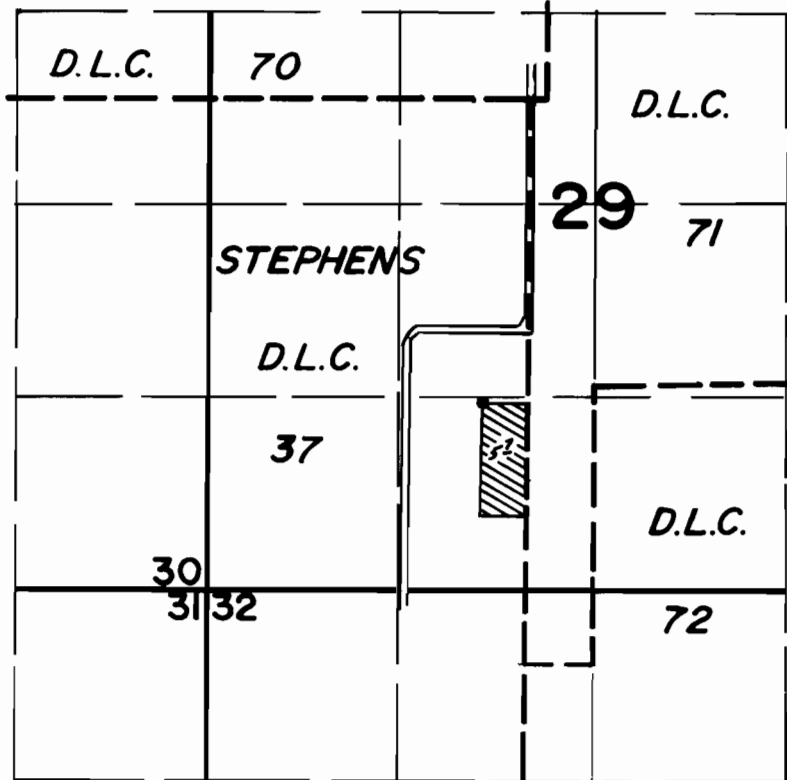

Well Loc. - 1280' N & 1880' E from SW Cor. Sec. 29

FINAL PROOF SURVEY UNDER

Application No. G-5513 Permit No. G-5406
IN NAME OF

ANTON PFAU, JR.

Surveyed Oct. 9, 1978, by J.S. Donaldson.