

T.5&6S., R.3&4W., W.M.

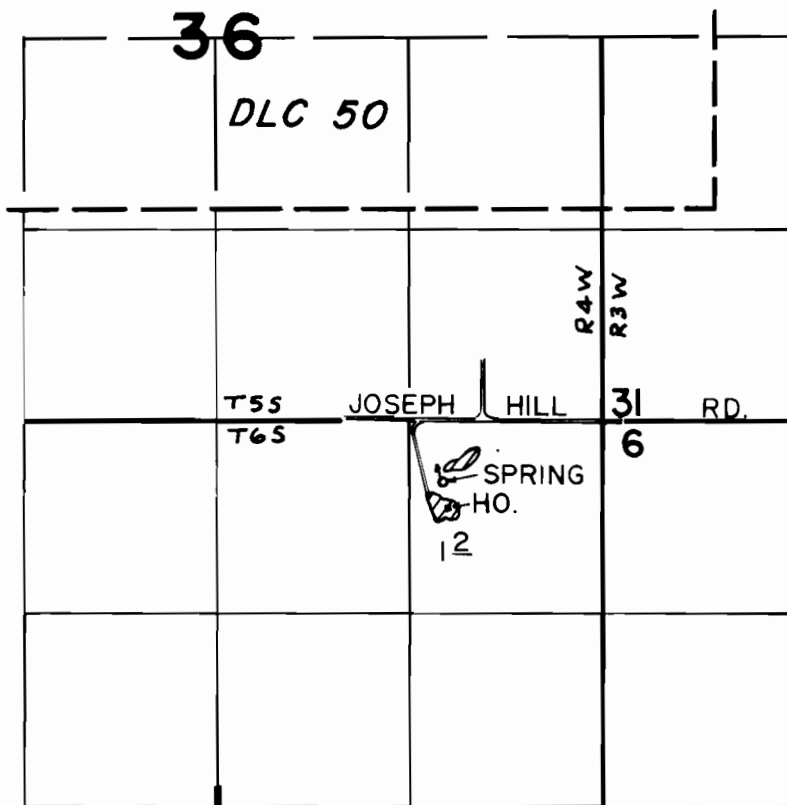

SPRING LOC. 420'S. & 1100'W. FROM NE COR. SEC. 6

FINAL PROOF SURVEY UNDER

Application No. 52966 Permit No. 39985
IN NAME OF

LEO R. HAMMER

Surveyed JULY 18, 1978, by J.S. DONALDSON