

# T. 11S. R. 4W. W.M.

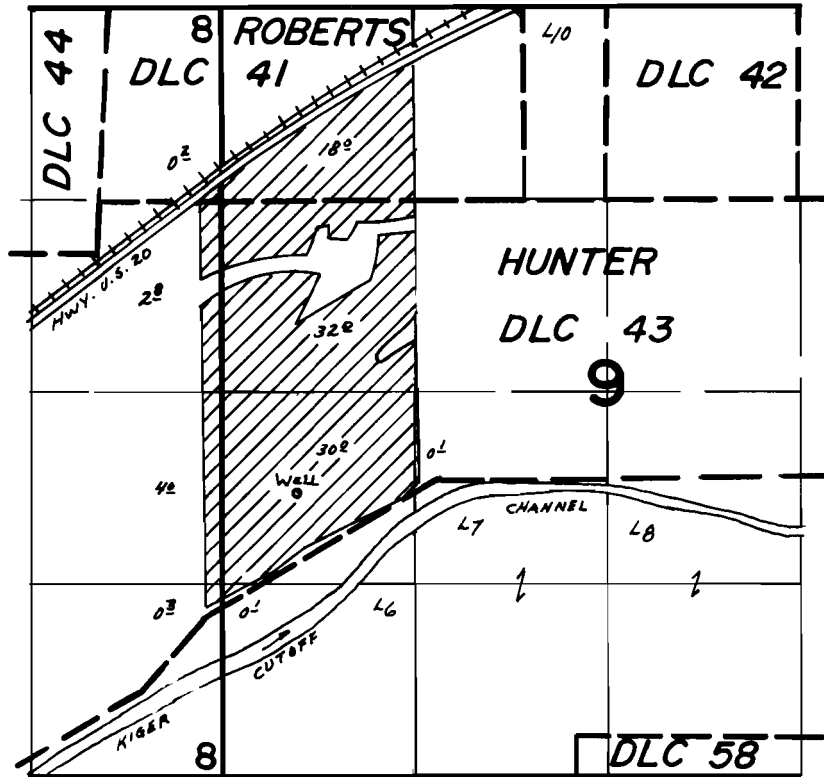

Well Loc. - 3330'S & 510'E From NW Cor. Sec. 9

## FINAL PROOF SURVEY UNDER

Application No. G-7755. Permit No. G-7201.  
IN NAME OF

ROBERT L. RICKERT

Surveyed April 11, 1978, by J.S. Donaldson