

T. 4N., R. 2W., W.M.

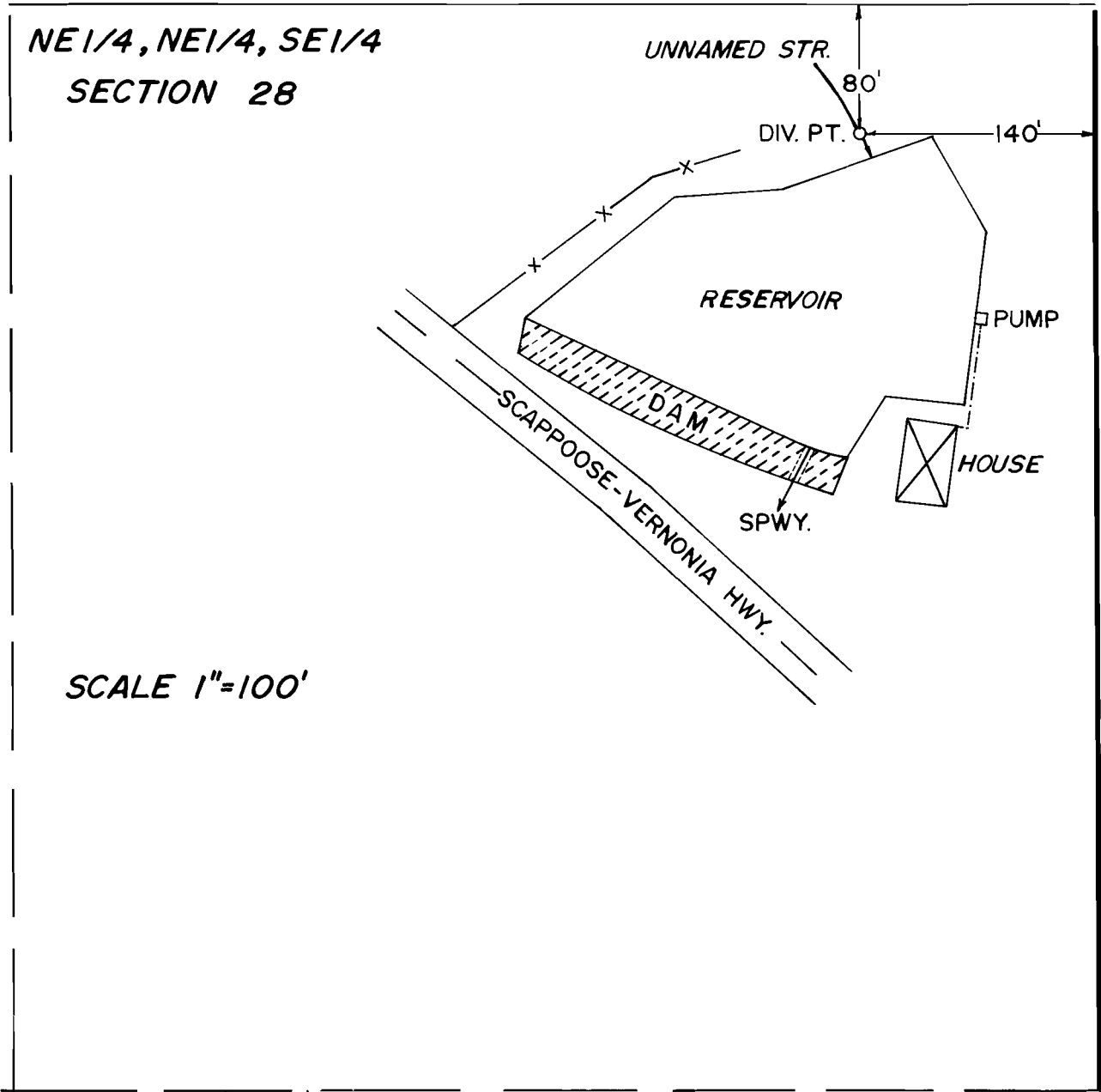

RES. DIV. PT. LOC. 280' S. & 180' W. FROM E. 1/4 COR. SEC. 28

FINAL PROOF SURVEY UNDER

R-49351 R-6006
Application No. 49352... Permit No. 36996.....
IN NAME OF

ALOIS & FRANCES HEINEN

Surveyed April...26 1978., by L. H. NUNN.....