

T. 37 S., R. 5 & 6 W., W.M.

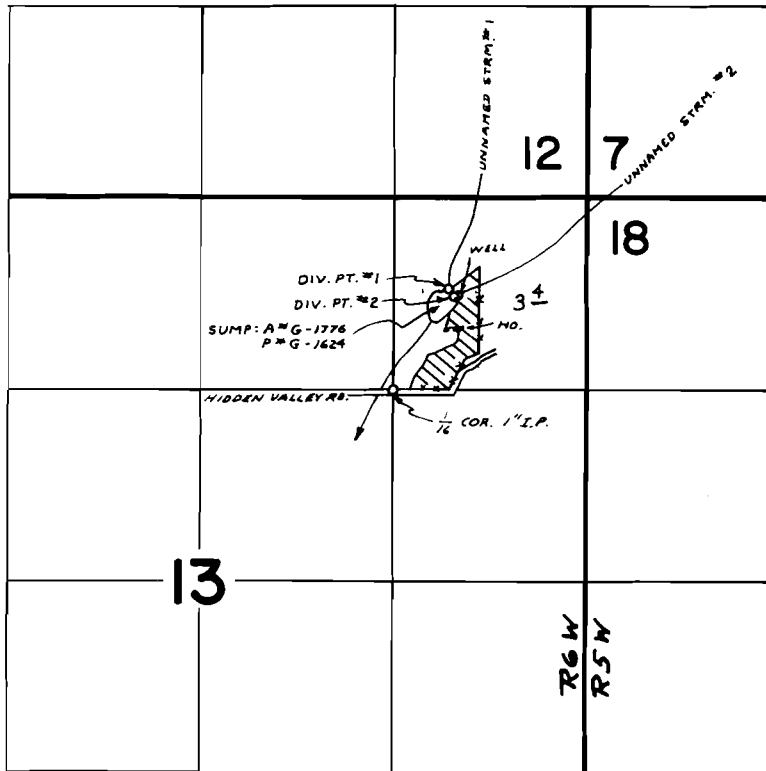

WELL LOC. : 670' S & 870' W FROM NE COR. SEC. 12
 DIV. PT. #1 LOC. : 620' S & 940' W FROM NE COR. SEC. 12
 DIV. PT. #2 LOC. : 680' S & 890' W FROM NE COR. SEC. 12

FINAL PROOF SURVEY UNDER

G-7171 G-6610 SUPPL.
 Application No. 55596 Permit No. 41662 SUPPL.
 IN NAME OF

..... DON T. & MARILYN J. WADE

Surveyed OCT. 14 77 by B. SUND
 19....., by