

T. 4N. R. 28 & 29E. W.M.

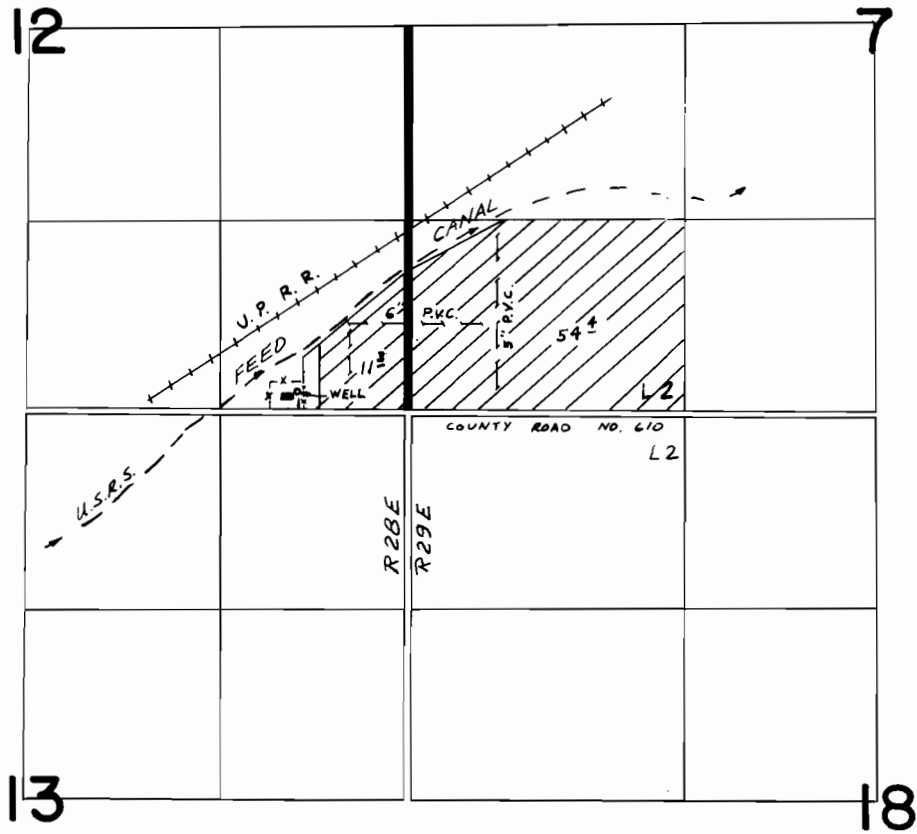

WELL LOC. 760'W & 150'N FROM SE COR SEC 12

FINAL PROOF SURVEY
UNDER

Application No. G-6744.. Permit No. G-6268..
IN NAME OF

..... FRANK E. & DOYLENE M. DYE

Surveyed 11-30..... 1977, by R. BARWIN.....