

# T. 11 S., R. 13 E., W.M.

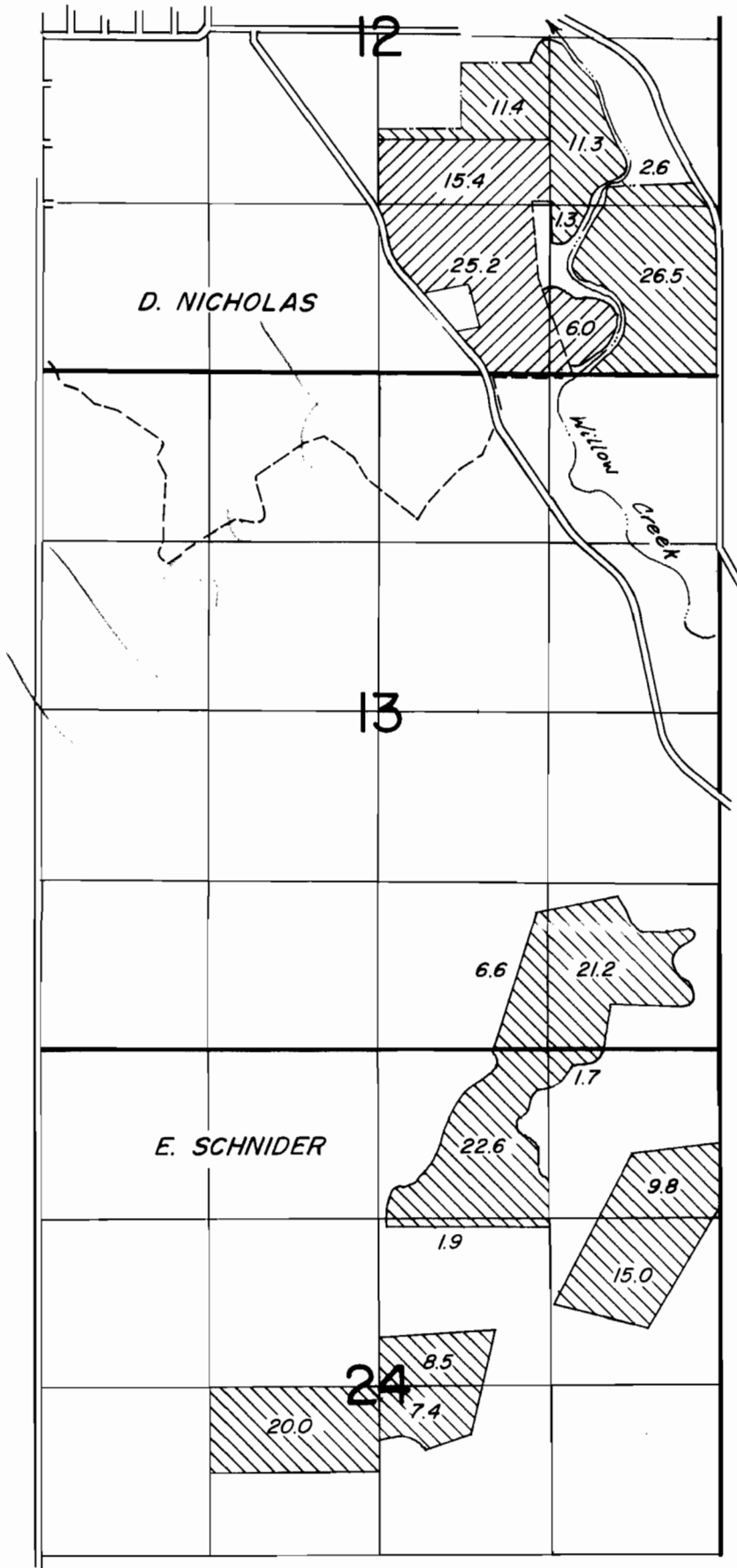

## FINAL PROOF SURVEY

 DESCHUTES RIVER LANDS

UNDER

 CROOKED RIVER LANDS

R-24920

R-1677

24921

23196

R-30129

R-1754

30083

25921

Application No. 45404 Permit No. 33954

IN NAME OF

### NORTH UNIT IRRIGATION DISTRICT

Surveyed 1978-79, by L.H. NUNN

*Handwritten note:*  
 This is a final proof of a  
 partial proof, but North Unit  
 should not use it.  
 A