

T.39S.R.35E.W.M.

Permit G-4156

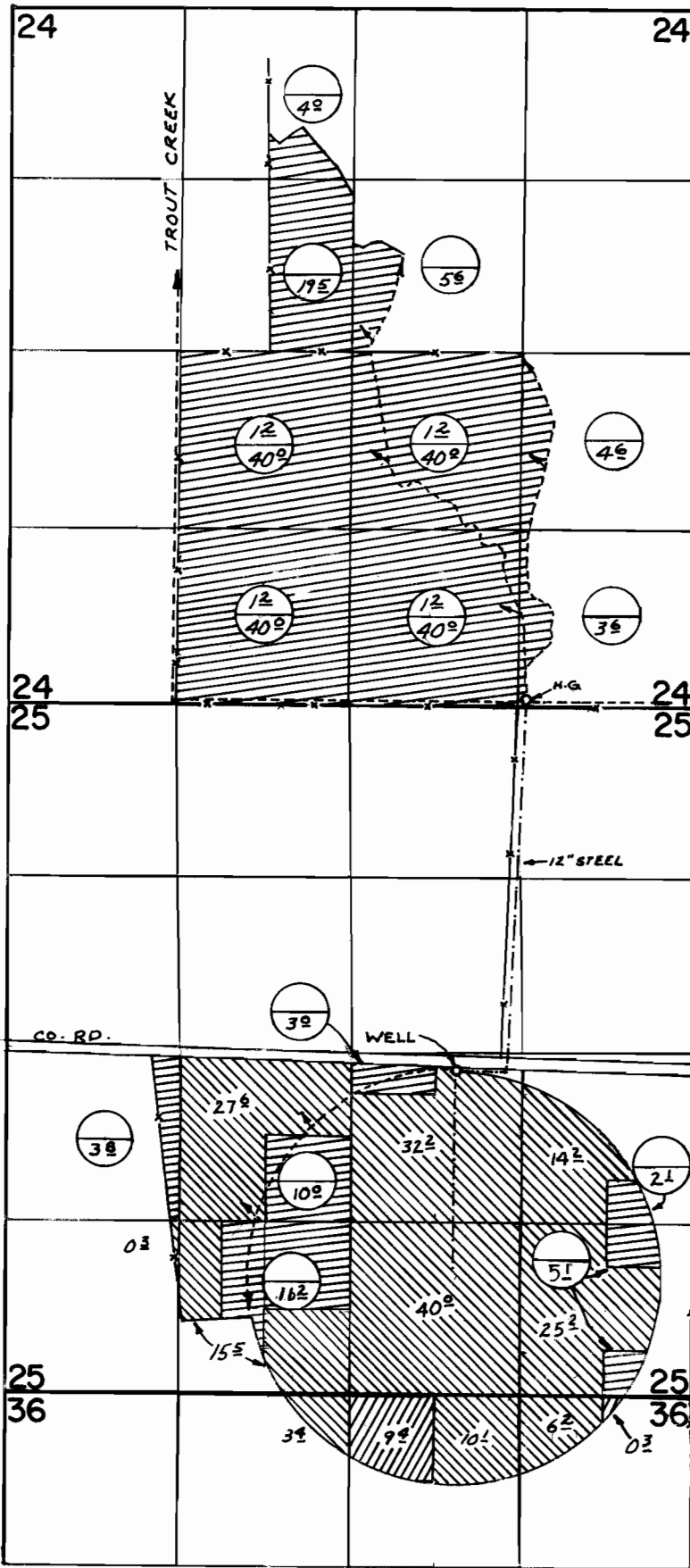

Permit G-4155

WELL LOC: 2500' N. & 1830' W. FROM S.E. COR. SEC. 25

FINAL PROCEEDING SURVEY

UNDER

Application No. ~~G-4409~~ ~~G-4410~~ Permit No. ~~G-4155~~ ~~G-4156~~

IN NAME OF

DON S. ORLANDO - TROUT CR. RANCH

Surveyed JUNE 16 1976 by R. MUCKEN