

T.36 S. R.6 W, W.M.

RECEIVED

SEP 1 1978

WATER RESOURCES DEPT.
SALEM, OREGON

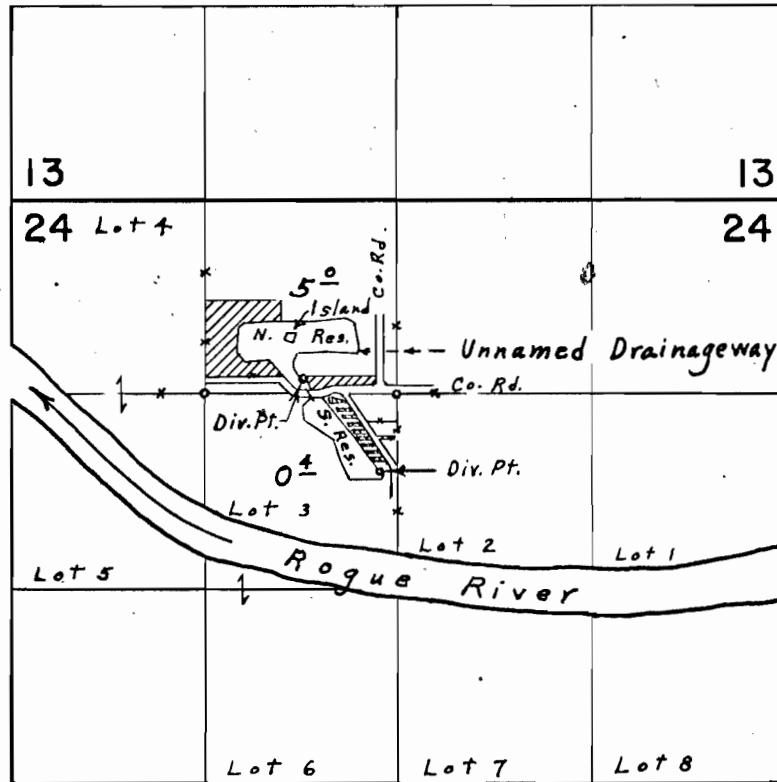

Div. Pts. loc.: N. Res., 100' N. & 630' W.; S. Res., 530' S. & 120' W.,
both from S.E. Cor. N.E. $\frac{1}{4}$ N.W. $\frac{1}{4}$ Sec. 24

FINAL PROOF SURVEY
UNDER

R-45466 R-5374
45420 33905
R-43698 R-5290
Application No. 43699 Permit No. 33794
IN NAME OF

CONSOLIDATED PIPELINE CO., INC.

Surveyed April 24 1974, by L. E. Gould