

T.36 S. R.6 W. W.M.

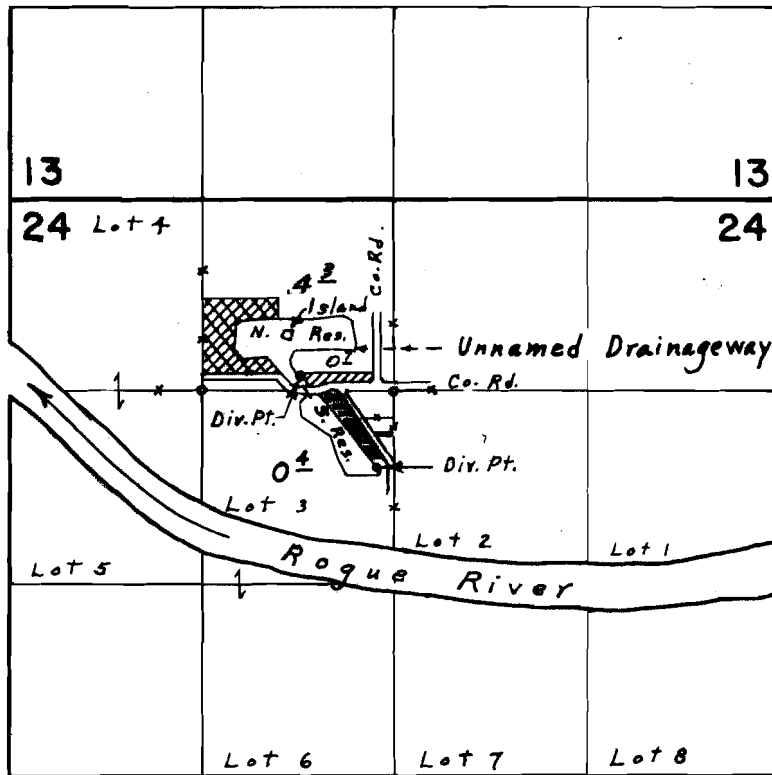

Div. Pts. loc.: N. Res., 100' N. & 630' W.; S. Res., 530' S. & 120' W.,  
both from S.E. Cor. N.E. & N.W.  $\frac{1}{4}$  Sec. 24

**FINAL PROOF SURVEY**  
UNDER

R-45466                      R-5374  
45420                      33905  
R-43698                      R-5290  
Application No. 43699... Permit No. 33424

IN NAME OF

**CONSOLIDATED PIPELINE CO., INC.**

Surveyed April 24 1974, by L. E. Gould