

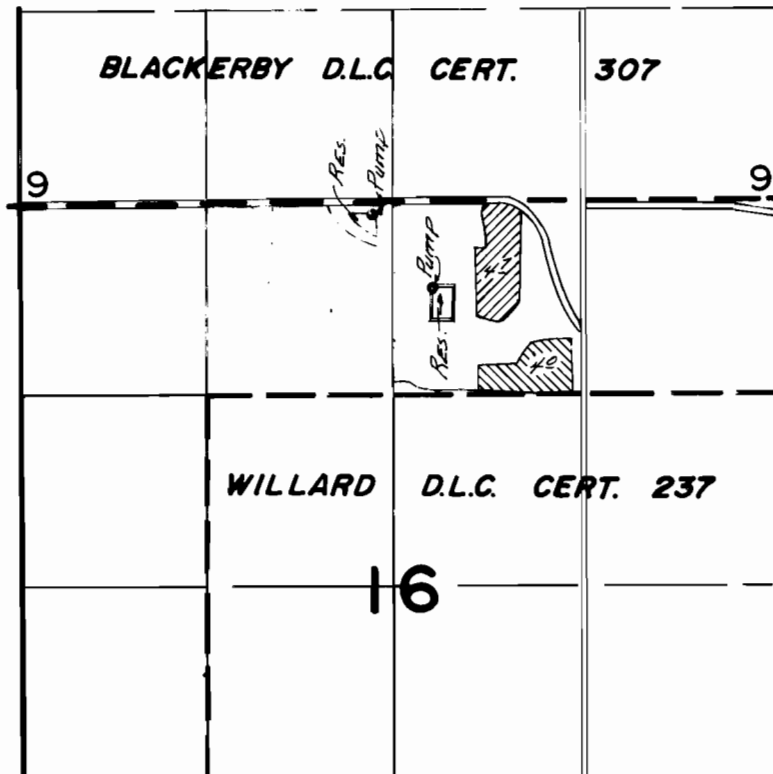

# T. 7S. R. 1W. W.M.



RES. DIV. 590' S & 260' E FROM N/4 COR. SEC. 16

 → PRIMARY  
 → SUPPL.

## FINAL PROOF SURVEY UNDER

Application No. 46871... Permit No. 35042...  
IN NAME OF

JEROME GEHRING

Surveyed April 26 1973, by R.G. Mucken