

T. 3N. R. 28E. W. M.

T. 3N. R. 29E. W.M.

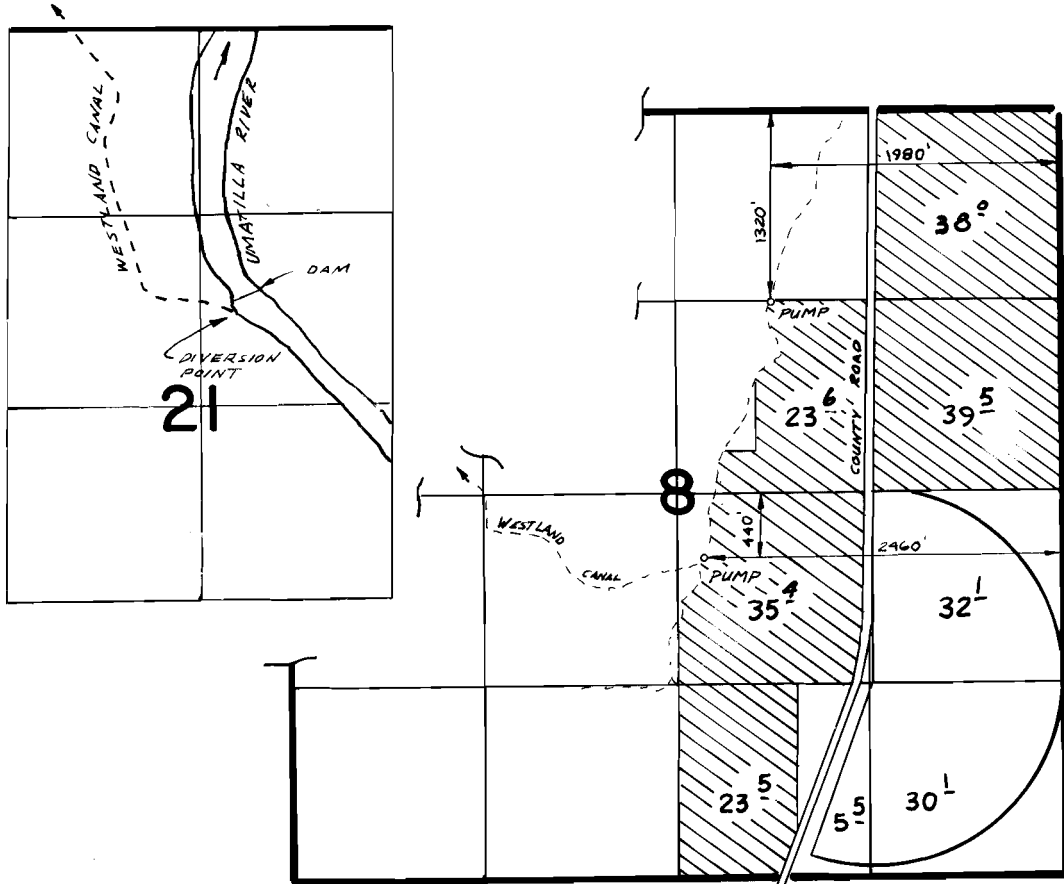

DIVERSION POINT LOCATED N. 76° 45' 56" E. 2913.19' FROM W. 1/4 COR SEC 21
T3N R29E WM

FINAL PROOF SURVEY
UNDER

Application No. 53935 Permit No. 40238
IN NAME OF

HENRY F. WALKER

Surveyed 2-16 1979, by R. BARWIN