

T17S. R6W. WM.

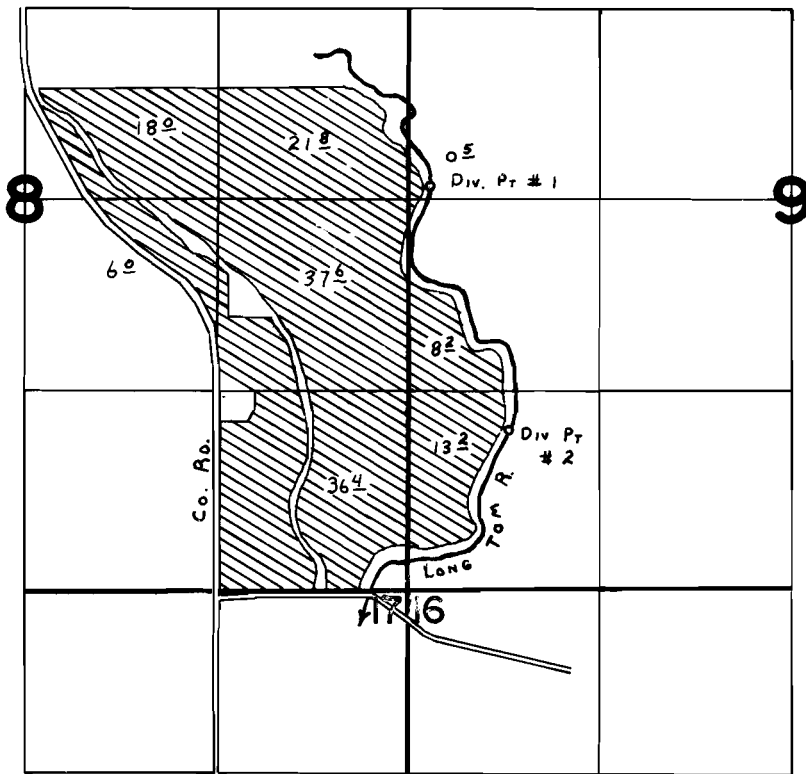

DIV. PTS. Loc: #1- 2780'N. & 150'E. } BOTH FROM S.W. COR. SEC. 9.
#2- 1090'N. & 690'E. }

FINAL PROOF SURVEY UNDER

Application No. 48504 Permit No. 36395
IN NAME OF

K. E. R. Farms

Surveyed JUNE 14 1978, by C. L. HUGHES