

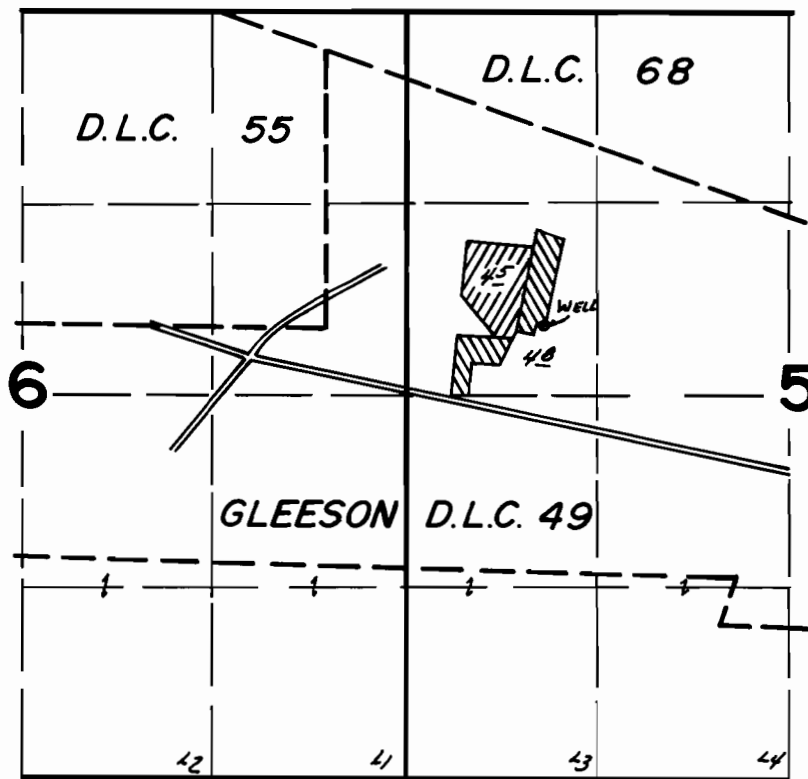

T.5S.R.1W.W.M.



WELL LOC. - 470' N + 950' E from W 1/4 Cor. Sec. 5

-  - SUPPL.
-  - PRIMARY

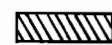
FINAL PROOF SURVEY UNDER

Application No. G-7456. Permit No. G-6948.
IN NAME OF

.....KAREN L. GREGORY.....

Surveyed Aug. 15, 1978., by J.S. Donaldson....