

T.26S. R.4W. W.M.

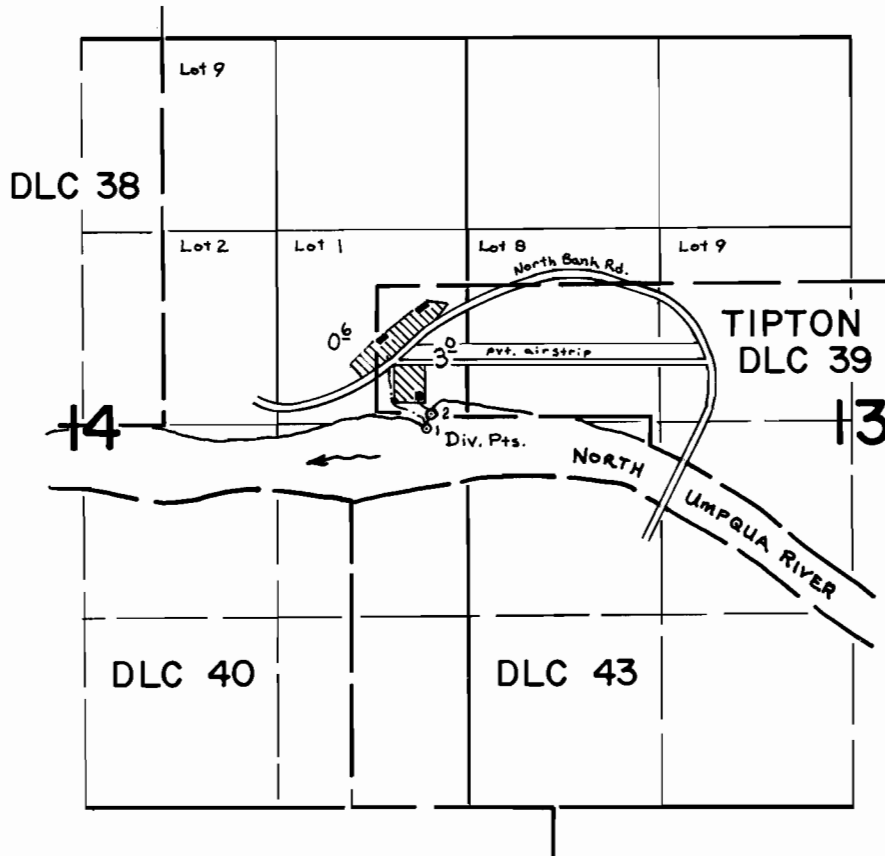

Div. Pts. Located: 1- 20'S $\frac{1}{4}$ 300'W; 2- 40'N $\frac{1}{4}$ 260'W; from E $\frac{1}{4}$ cor. Sec. 14

SCALE: 4" = 1 mile

FINAL PROOF SURVEY UNDER

Application No. 51691 Permit No. 38972
IN NAME OF

.....FERREN, RAMSEY, & BARRITT.....

April 23, 1979 S. Donaldson

Surveyed Sept. 29, 1976., by L.H. Nunn.....