

# T. 6S., R. 6W., W.M.

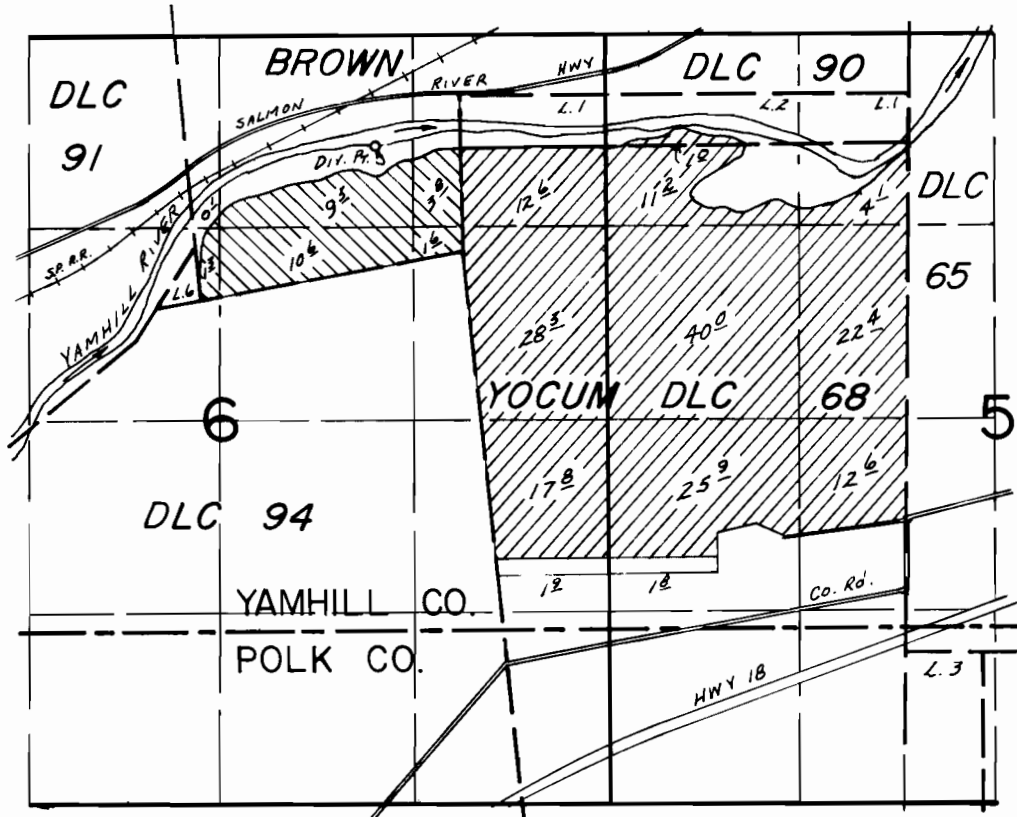

Div. Pt. Loc. 720' N. & 600' W. FROM NE COR. DLC 94

 TURNER  
 WOODCOCK

## FINAL PROOF SURVEY UNDER

Application No. 42952..... Permit No. 32088.....  
IN NAME OF

.....Turner-Woodcock.....

Surveyed SEPT. 7.... 19.77., by L. H. NUNN.....