

G 6770
51594

T.27S. R.17E. W.M.

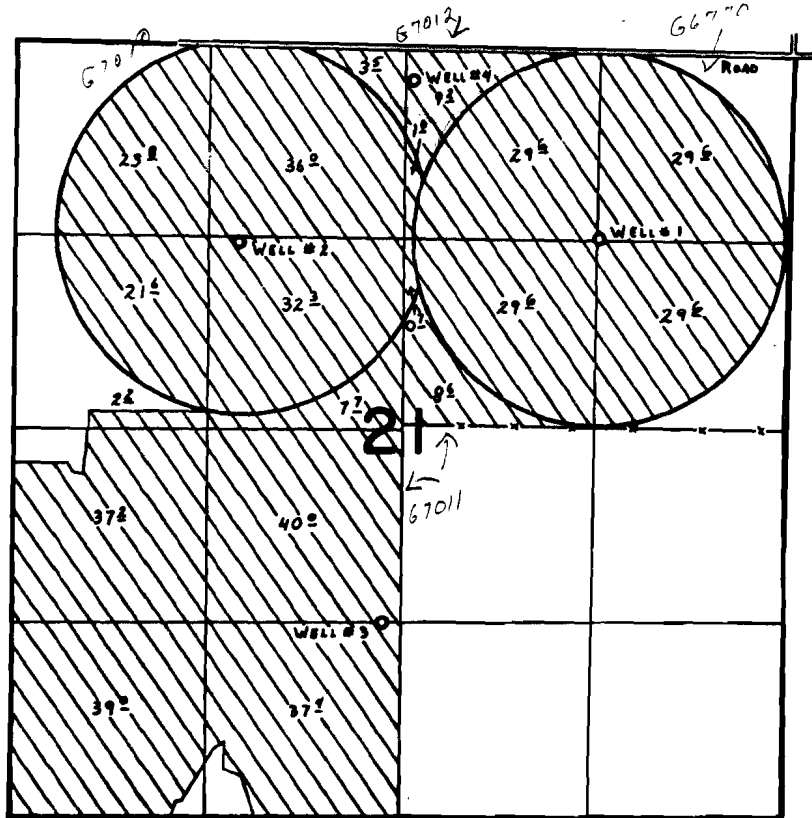

WELLS Loc:
 #1- 1280'S. { 1300'W. }
 #2- 1350'S. { 3770'W. }
 #3- 3780'S. { 2750'W. }
 #4- 220'S. { 2610'W. }
 ALL FROM N.E. COR. SEC. 21.

FINAL PROOF SURVEY UNDER

G-7332
 G-7539
 G-7540

G-6770
 G-7010
 G-7011

Application No. G-7541. Permit No. G-7012.
 IN NAME OF

HASKEL & SHIRLEY A. BLACK

Surveyed Aug. 28, 1978, by S.P. APPLIGATE