

G 6770  
51594

# T.27S. R.17E. W.M.

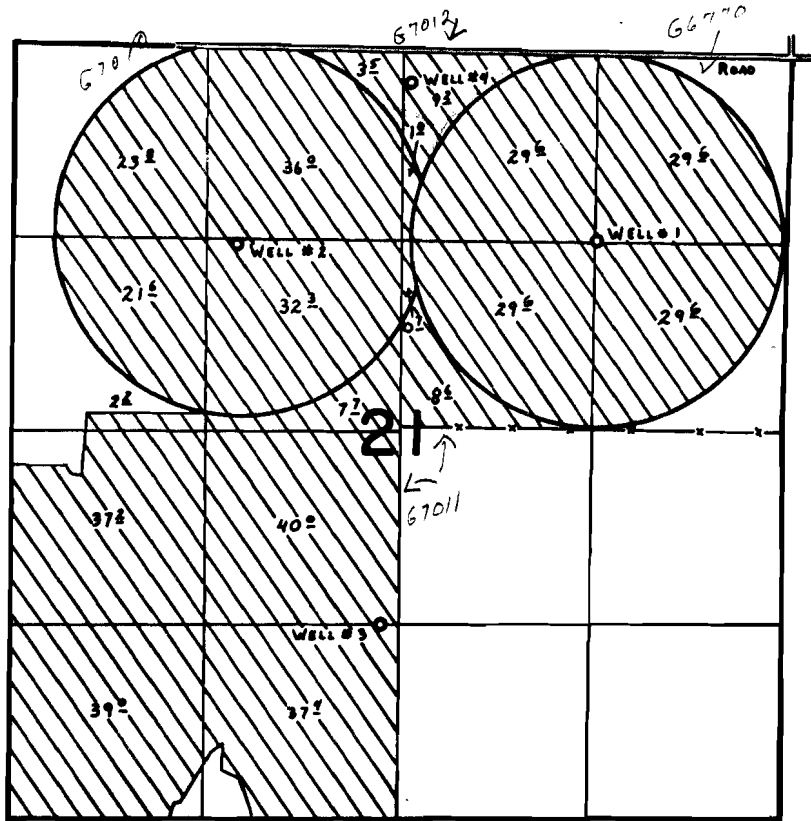

WELLS LOC:  
 #1- 1280'S. & 1300'W.  
 #2- 1350'S. & 3770'W.  
 #3- 3180'S. & 2750'W.  
 #4- 220'S. & 2610'W.  
 } ALL FROM N.E. COR. SEC. 21.

## FINAL PROOF SURVEY

UNDER

G-7332  
G-7539  
G-7540

G-6770-C# 51574  
G-7010-C# 51571  
G-7011-C# 51570

Application No. ~~G-7541~~ Permit No. ~~G-7012~~ C# 51573

IN NAME OF

.....*HASKEL & SHIRLEY A. BLACK*.....

Surveyed Aug...28... 19.78., by *S.P. APPLIGATE*