

G 6770  
51594

# T.27S. R.17E. WM.

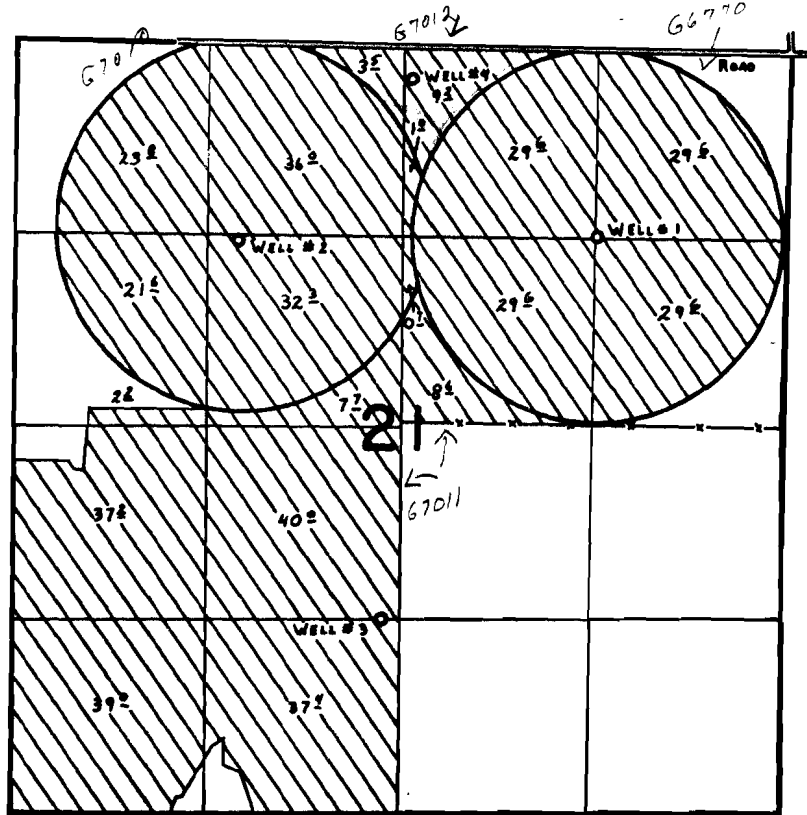

WELLS Loc:  
#1- 1280'S. & 1300'W.  
#2- 1390'S. & 3770'W.  
#3- 3120'S. & 2750'W.  
#4- 220'S. & 2610'W.  
ALL FROM N.E. COR. SEC. 21.

## FINAL PROOF SURVEY

UNDER

G-7332  
G-7539  
G-7540

G-6770 - C# 51594  
G-7010 - C# 51594  
G-7011 - C# 51594

Application No. G-7541. Permit No. G-7012. C# 51594

IN NAME OF

.....HASKEL & SHIRLEY A. BLACK.....

Surveyed Aug...28.. 19.78., by S...P...APPLEGATE