

T. 8S. R. 46E. W. M.

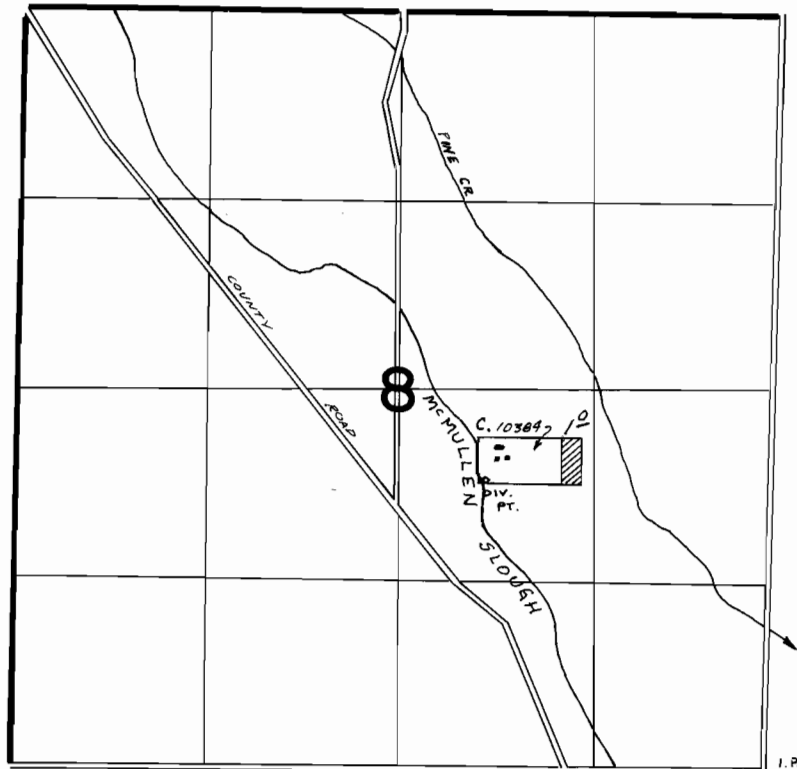

DIV. PT. LOC. 620'S & 590'E FROM CENTER SEC 8

FINAL PROOF SURVEY
UNDER

Application No. 54062..... Permit No. 40431.....
IN NAME OF

.....**WERNER J. OMANN**.....

Surveyed 5-30..... 1978., by R. FARWIN.....