

T. 4S., R. 1E., W.M.

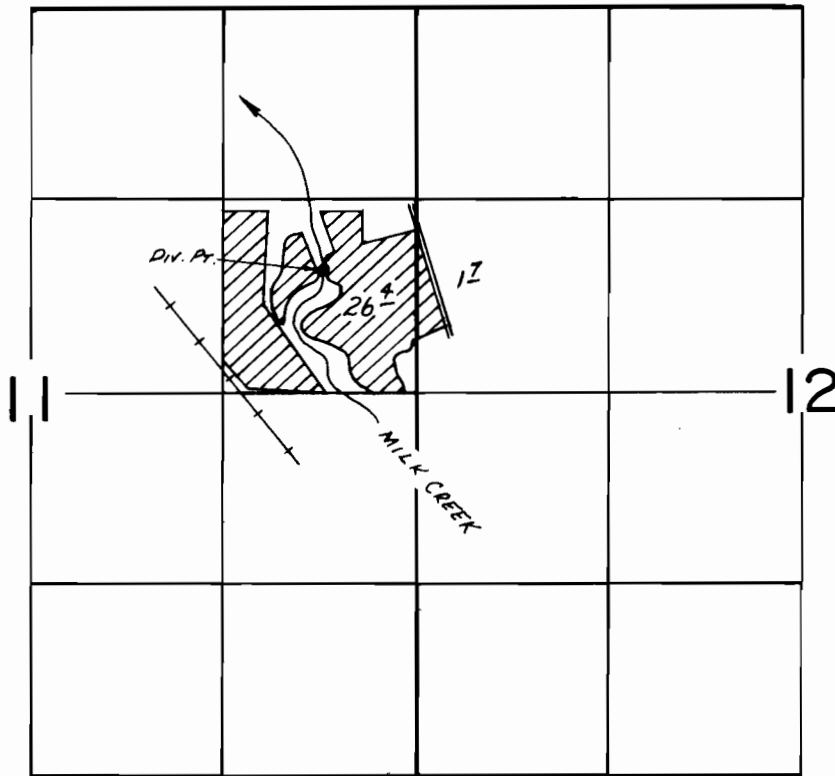

Div. Pt. Loc: 850' N. & 620' W. FROM E. 1/4 COR. SEC. 11

FINAL PROOF SURVEY
UNDER

Application No. 55148... Permit No. 41342.....
IN NAME OF

.....HOWARD L. KASCH.....

Surveyed AUG. 14. 1981., by S. C. BROWN.....