

T. 41 S., R. 9 W. W.M.
 SEC. 11

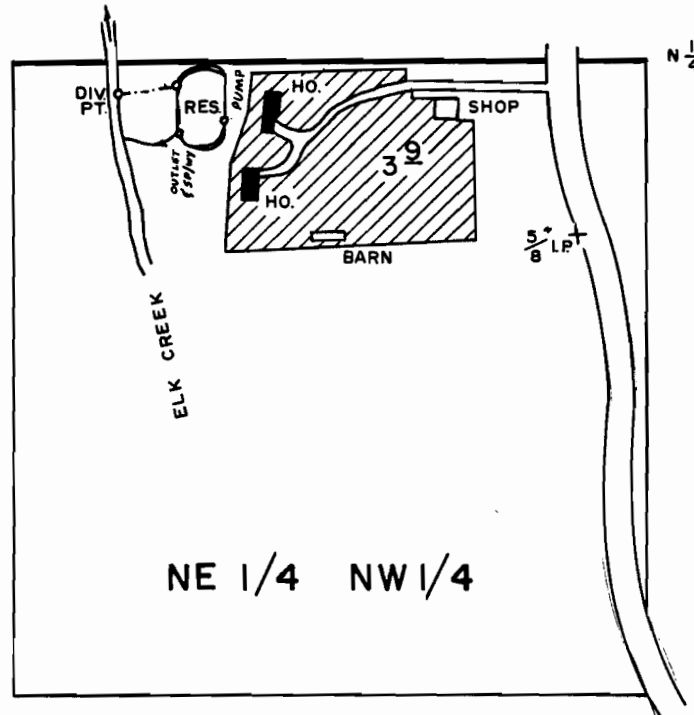

DIV. PT. : 60'S & 1100' W FROM N 1/4 COR. OF SEC. 11.
 RESERVOIR: 100'S & 920' W FROM N 1/4 COR. OF SEC. 11.

FINAL PROOF SURVEY
 UNDER

57887 43841

Application No. R-58200 Permit No. R-7785....

IN NAME OF

JAMES R. & HARRY R. BROWN.....

Surveyed AUG. 27. 1982, by B.R. SUND.....

Scale : 1" = 400'