

INCHOATE RIGHT SURVEY
COW CREEK ADJUDICATION

DOUGLAS COUNTY OREGON

OFFICE OF THE STATE ENGINEER
SALEM OREGON
JUNE 1936
PRESENT OWNER GEO. W. TURNER

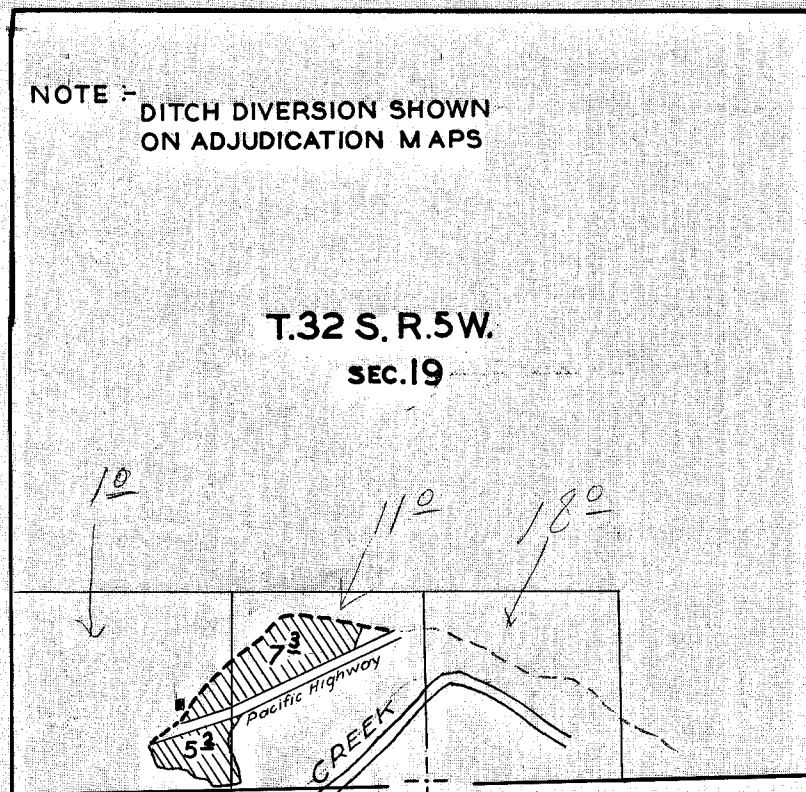

IRRIGATED LAND
DITCH
SECTION CORNER

