

MAP
OF
PROPOSED WATER SYSTEM
NEAR MILLINGTON
COOS COUNTY OREGON.

STATE ENGINEER
REGISTERED
S. B. CATHCART
SALEM, OREGON

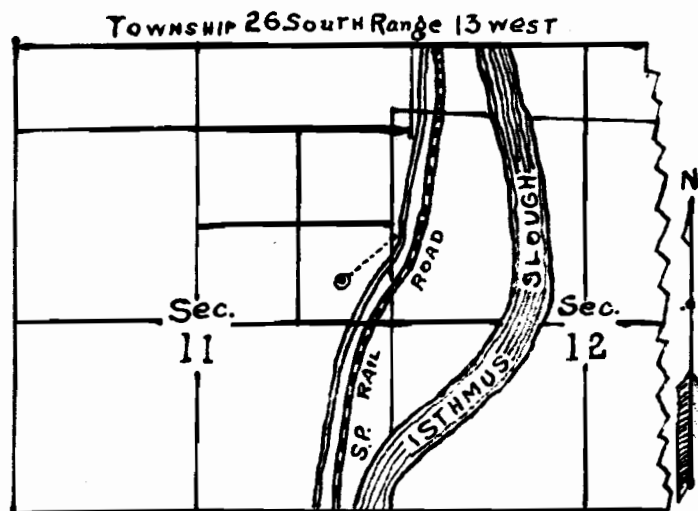

SCALE ONE INCH = 40 CHAINS

State of Oregon }
County of Coos } SS

I S. B. Cathcart of Marshfield Oregon do hereby certify that this map was made from field notes taken during an actual survey made by me June 6th 1924, and that it correctly represents the position of the diverting point of the water

from a small unnamed stream, a tributary of isthmus slough. Said point is situated in the S.E. 1/4 of the N.E. 1/4 of sec 11 T. 26 S. R. 13. W. Will. Mer. and from which point the 1/4 section cor. between sections 11 & 12 bears S42° 47' E 18.06 chains. The dotted line shows approximately where the pipe line will run, but was not actually surveyed.

S. B. Cathcart.....

Surveyor.

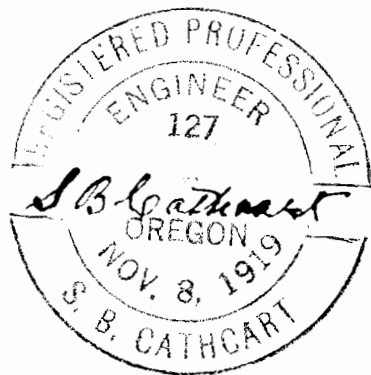

Application No. 7003
Permit No. 6336