

T16S. R43E. WM.

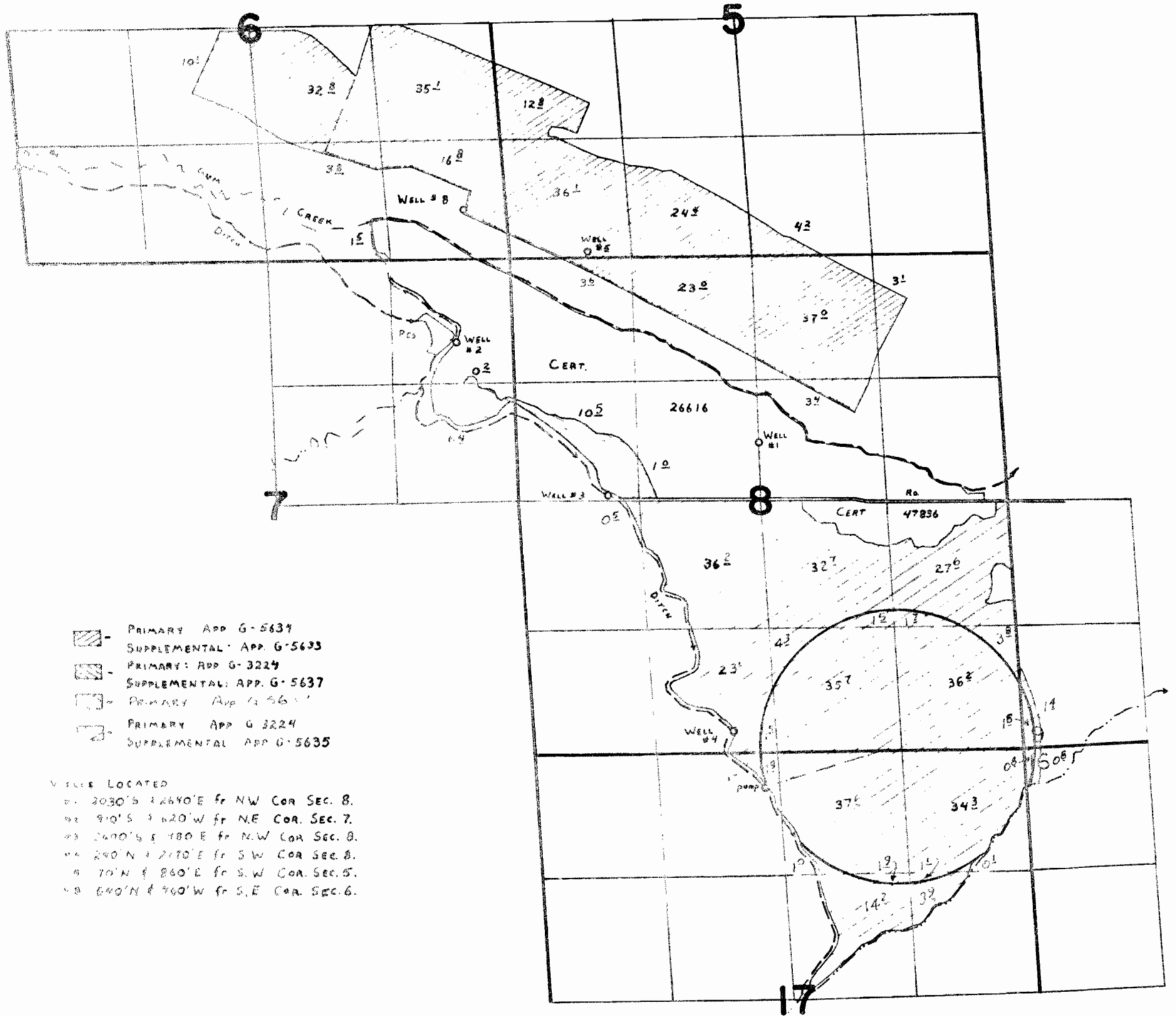

- PRIMARY APP G-5634
SUPPLEMENTAL APP G-5633
- PRIMARY APP G-3224
SUPPLEMENTAL APP G-5637
- PRIMARY APP G-5635
- PRIMARY APP G-3224
SUPPLEMENTAL APP G-5635

WELLS LOCATED
 #1 2030'S 42640'E fr NW COR SEC. 8.
 #2 910'S 4620'W fr NE COR SEC. 7.
 #3 2490'S 4780'E fr NW COR SEC. 8.
 #4 240'N 42170'E fr SW COR SEC. 8.
 #5 70'N 4860'E fr S.W. COR. SEC. 5.
 #8 640'N 4760'W fr S.E. COR. SEC. 6.

FINAL PROOF SURVEY UNDER

G-5633	G-6719
G-5634	G-6720
G-5635	G-6721
Application Nos. G-5637	Permit Nos. G-6723
G-3224	G-3167

IN NAME OF

**GUM CREEK FARMS, INC. &
KANSAS CITY LIFE INS CO**

Surveyed AUG. 6 1979, by C. L. HUGHES
SEPT 20