

T. 3N., R. 28E., W. M.

FINAL PROOF SURVEY
UNDER

APPL. G-7343
G-7598
G-7441
G-9205

PER. G-6893
G-7036
G-6936
G-8570

IN NAME OF

L & L FARMS

SURVEYED MAY 13, 1982, BY *V.L. Church*

WELL 1 Loc: 960' N. + 30' E. FROM S 1/4 COR. SEC 23

WELL 2 Loc: 930' S. FROM N 1/4 COR. SEC 26

WELL 3 Loc: 60' S. + 820' E. FROM N 1/4 COR. SEC 23

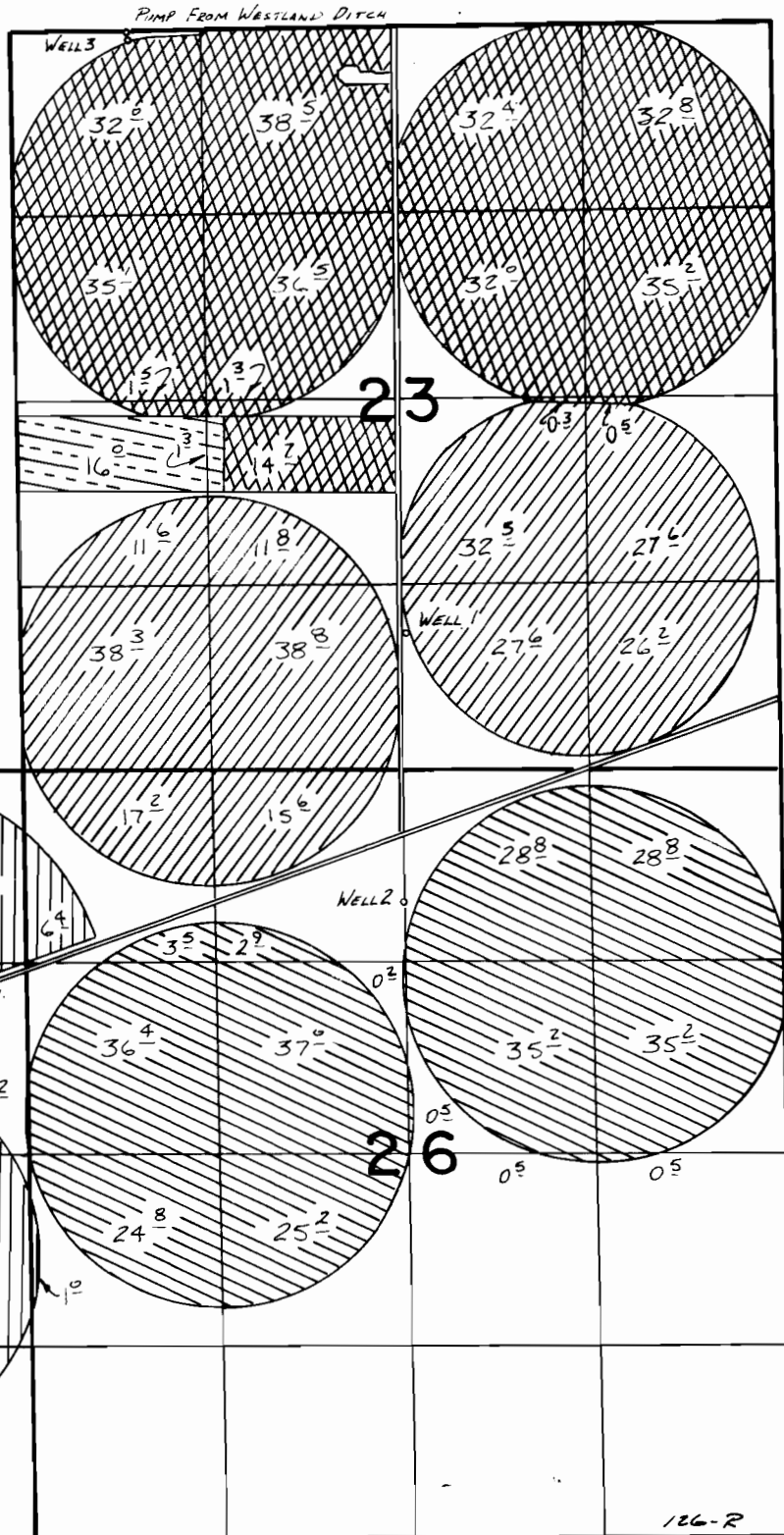
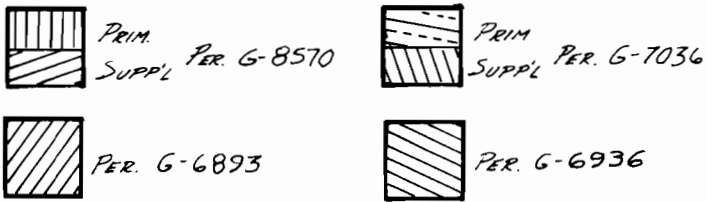

T. 3N., R. 28E., W.M.

UMATILLA COUNTY

SCALE 1" = 1320'

WATER RIGHTS TRANSFER MAP

IN NAME OF

L & L FARMS

Water Rights Transferred To These Locations



PERMIT #G-6893
CERT. #51786



PERMIT #G-6936
CERT. #51784



PERMIT #G-7036
CERT. #51785
PRIMARY



PERMIT #G-7036
CERT. #51785
SUPPLEMENTAL

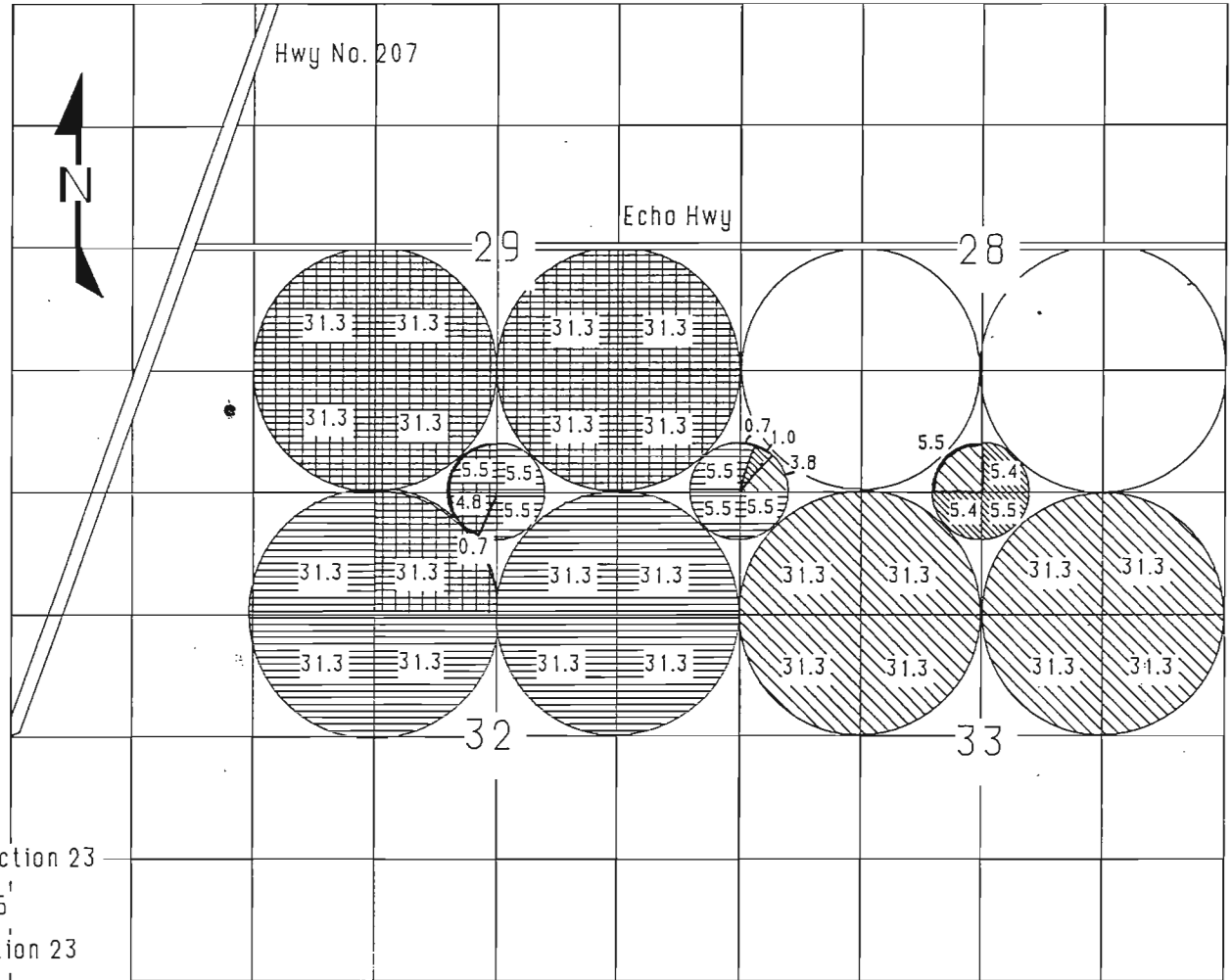

Well 1 Located 960' N. & 30' E. from S. 1/4 Corner Section 23

Well 2 Located 930' S. from N. 1/4 Corner Section 26

Well 3 Located 60' S. & 820' E. from N.W. Corner Section 23

THIS MAP IS FOR THE PURPOSE OF IDENTIFYING THE LOCATION OF WATER RIGHTS ONLY AND IS NOT INTENDED TO PROVIDE LEGAL DIMENSIONS OR LOCATIONS OF PROPERTY OWNERSHIP LINES.

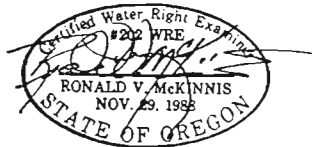

RECEIVED

JUL - 9 1990

WATER RESOURCES DEPT.
SALEM, OREGON

ENGINEERING - SURVEYING - WATER RIGHTS
R V MCKINNIS ENGINEERING
Rt 1 Box 1122 Hermiston, Oregon 97838
503-567-2017