

T.22S. R.7W. W.M.

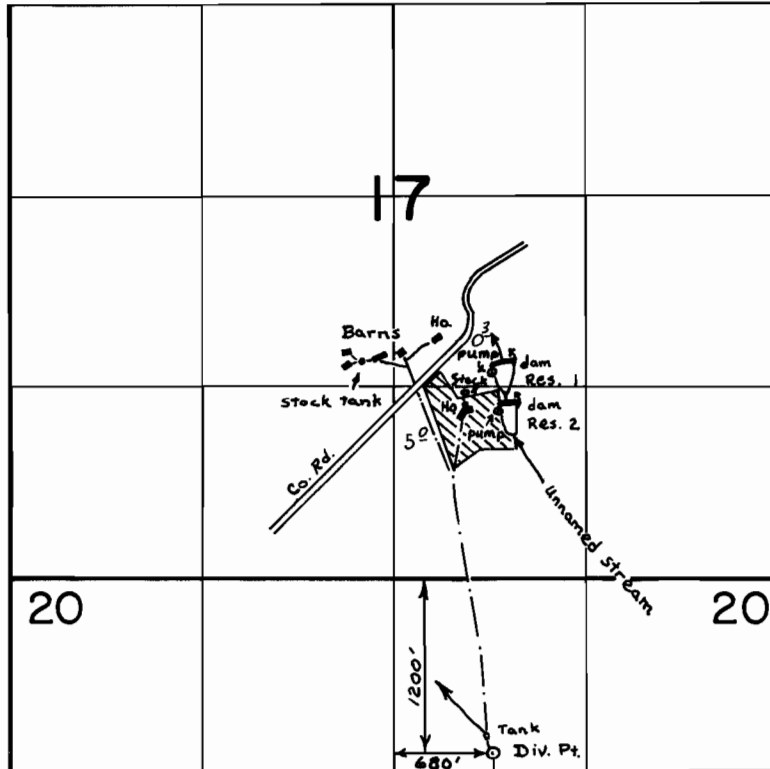

Dams located: 1-1500' N & 750' E
2-1200' N & 770' E
from S 1/4 cor. sec. 17

SCALE: 4" = 1 mile

FINAL PROOF SURVEY

UNDER

50984

38481

R-52095

R-6288

Application No. 52096 Permit No. 39251

IN NAME OF

John David Garcia

Surveyed Aug. 29, 1979, by S. Donaldson